



Approval Marks



- LWDC36W1000NLR-T2CH-W
- LWDC36W1000NLR-T2CH-B
- LWDC36W1000NLR-T2CH-G



Item	Value	Remark	
Nominal voltage	220–240V		
Nominal frequency	50–60Hz		
AC voltage range	198–264V		
DC voltage range (start)	NA		
DC voltage range (operation)	NA		
Nominal current	205mA		
Total Harmonic Distortion (THD)	< 10%	Full load @230VAC	
Power factor	0.6C-0.97	Min-load @ 240Vac and Full-load @ 220 Vac	
Displacement factor	0.6C-0.97	Min-load @ 240Vac and Full-load @ 220 Vac	
Efficiency	84% (Typ.)	Full load @230VAC	
No-load power	NA		
Stand-by power	< 0.5W		
Networked standby power	< 0.5W		
Protection class	II		
Inrush current	8A / 80 us		
Max.units per circuit breaker	Type B , 10A MCB	20	
	Type B , 16A MCB	31	
	Type C , 10A MCB	24	
	Type C , 16A MCB	39	
Earth leakage current	NA		
Output	Nominal voltage range		
	350 - 700mA	10-50 Vdc	
	800mA	10-45 Vdc	
	900mA	10-40 Vdc	
	1000mA	10-36 Vdc	
	Maximum voltage	60 Vdc	
	Output channels	2	
	Nominal current range	350-1000mA	DC Output with adjustable constant current from 350 to 1000 mA via NFC in 1mA steps. Factory default 350mA
	Current accuracy	± 5%	Full load @230VAC
	Typical output LF current ripple	± 5%	Low Frequency< 120Hz Full load @230VAC
Starting time	< 0.5 S	Full load @230VAC	

	Item	Value	Remark
Output	SVM	≤ 0.4	Full load @230VAC
	P _{stLM}	≤ 1	Full load @230VAC
	Nominal power range	3.5-36W	
	Maximum power	36W	
	Color tuning range	1500K-10000K	Adjusted via NFC program Factory default 2000K-10000K
Dimming	Dimming control	DALI	
	Dimming range	1-100%	
	Lowest dimming current	0.1%-2%	
	Dimming technique	Amplitude	
	PWM frequency	NA	
Galvanic isolation	Basic insulated to PRI and supplementary insulated to SEC		
Environment	Ambient temperature range t _a	-20°C - +35°C	
	Maximum case temperature t _c	80°C	
	Max. case temp. in fault condition	110°C	When operating under fault conditions, the temperature of the enclosure at any location should not exceed 110 °C
	Storage temperature range	-40°C - +85°C	
	Relative humidity	10% - 95%	
	Surge transient protection	1 kV	L/N
	Environmental rating	Indoor	
	IP rating	IP20	
	Mains switching cycles	>100,000	
	Expected lifetime	> 50,000 h, t _c 80 °C @ t _a 35 °C > 100,000 h, t _c 70 °C @ t _a 25 °C	0.2 % / 1,000 h failure rate 0.1 % / 1,000 h failure rate
Packing	Gross weight/box	7.0 kg	
	Net weight/box	6.0 kg	
	Pcs/box	35 PCS	
	Dimension/box	385(L)*310(W)*260(H)mm	
Protections			
Short-circuit Protection	Auto recovery		
Open-circuit Protection	Auto recovery		
Overload Protection	Auto recovery		
Conformity & Standards			
Safety standard:	EN 61347-1, EN 61347-2-13, EN 62493		
Performance:	EN 62384		
SAA standard:	AS/NZS 61347.1, AS 61347.2.13		
CCC standard:	GB17625.1, GB/T17743, GB19510.1, GB19510.14		
EMC standard:	EN 55015, EN 61000-3-2, EN 61000-3-3, EN 61547		
DALI protocol standard:	EN 62386-101, EN 62386-102, EN 62386-207, EN 62386-209		
Cable information			
SEC	+	-	
Cable cross-section	0.34-0.5□/AWG 22-20	0.34-0.5□/AWG 22-20	
Stripping	9mm	9mm	
Terminal information			
PRI -Contact metal			
SEC -Push button/Angled Entry			
DALI -Contact metal			

Subject to change without notice, HEP guarantees all products perform functionally well

* If not mentioned, all the test conditions are based on full load at 230VAC input (for 220-240 VAC input).

Current adjustable

NFC Reader (optional)

Feature:

Easily on-line read a output current from a driver or write a new current data to a driver throughout HEP NFC reader within few seconds.



APP NFC

Feature:

Quickly check output current of a LED driver simply via Android smart phone, as well as, correct or setup a new current data immediately with no extra equipment at any job site.

ICON



Main



QR Code

Google play



APK



Android 6.0 Up

Smart phone with a NFC function

Electrical Values

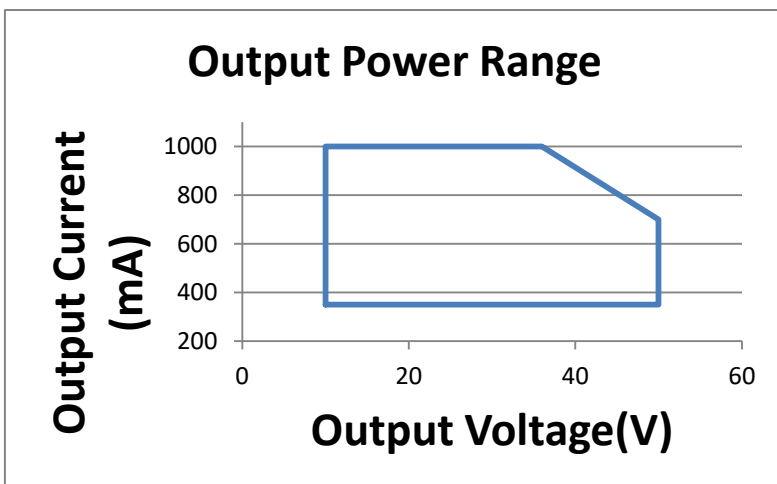

Output Current (mA)	Output Voltage Range (V)	Output Power Range (W)
1000	10-36	10.0-36.0
900	10-40	9.0-36.0
800	10-45	8.0-36.0
700	10-50	7.0-35.0
600	10-50	6-30.0
500	10-50	5.0-25.0
400	10-50	4.0-20.0
350	10-50	3.5-17.5

* Upon client's special demand, customized current range in between 350 mA and 1000 mA could be specified as factory default from shipment. This default current range available revised again via NFC reader program at client's site, if necessary.

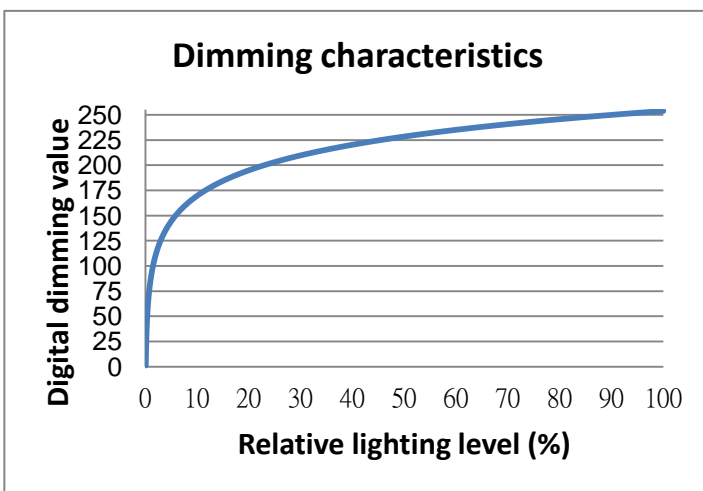

DALI-2 DT8 Control

Dimming up/down and CCT tuning are performed independently via DALI-2 DT8 dimmer.

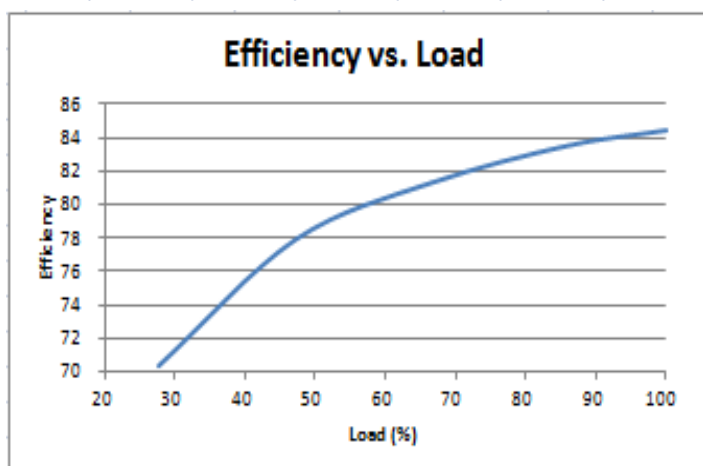
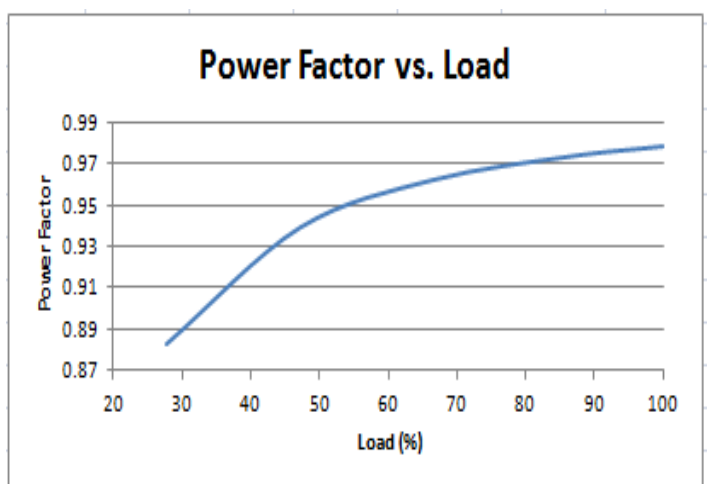
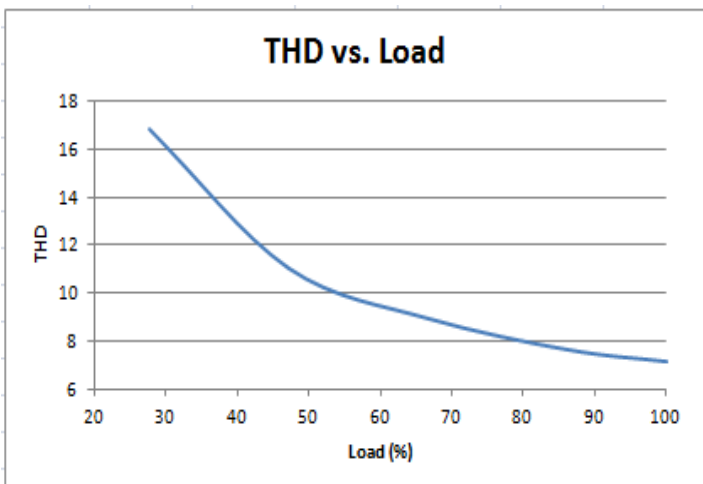
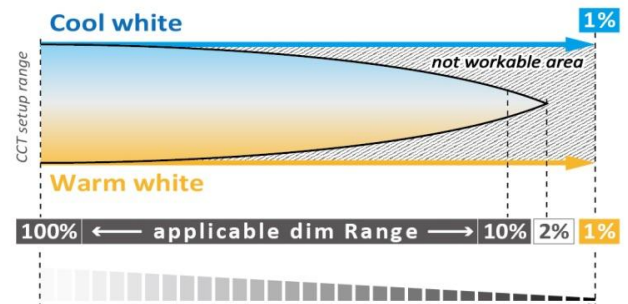

Label

HEP GROUP HEP GmbH - Ramsloh 10 58579 Schalksmuehle - Germany UN= 220-240Vac In= 205mA max. $\lambda = 0.6C-0.97$ $f_n = 50-60Hz$ $t_a = -20^{\circ}C - +35^{\circ}C$	LWDC36W1000NLR-T2CH Tunable White (DT8) Urange= 10-50 Vdc Irated= 350-1000mA const. Prated= 3.5-36W max. ratings Uout= 60V max. for output details see datasheet	CW LED2 WW LED1 SEC SELV $t_c = 80^{\circ}C$	GMA-513601 Top side NFC DALI 9mm wire preparation 0.34-0.5 IAWG 22-20	CE UK CA 110

Physical Parameter

L : 255.0 mm W1 : 33.0 mm
 W : 31.0 mm W2 : 41.5 mm
 H : 45.9 mm H1 : 43.4 mm
 N : 13.7 mm M : 136.2 mm
 K : 27.5 mm

Tolerance : $\geq \pm 1$ mm
 Housing Material : Polycarbonate

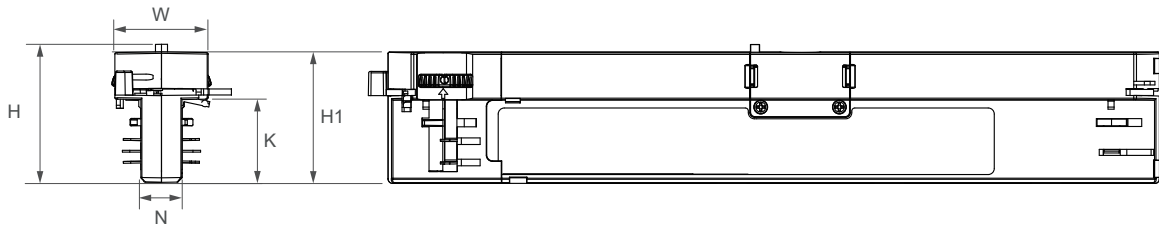
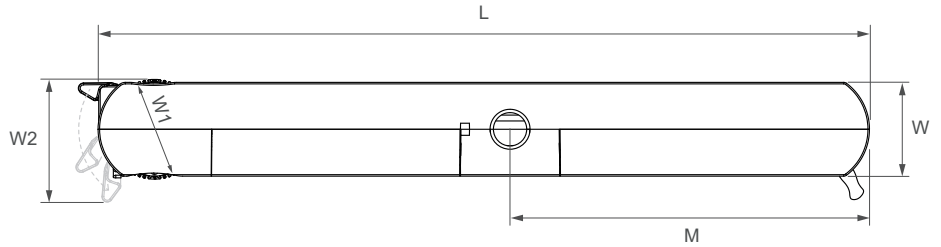

Wiring Diagram

DALI

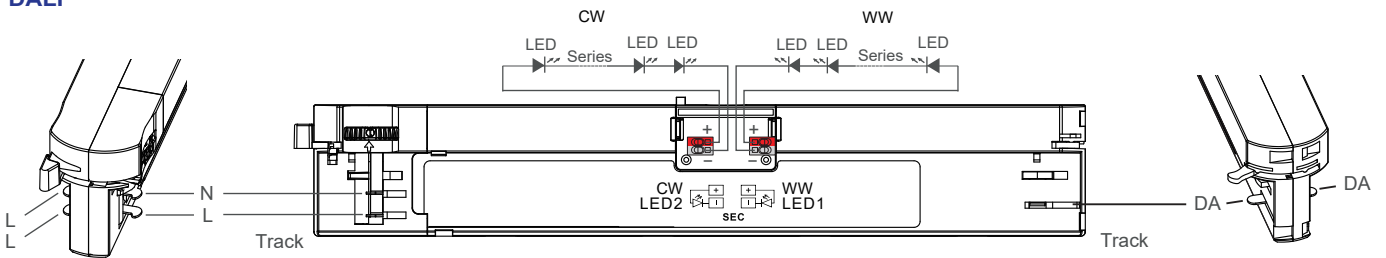

NFC Antenna Location

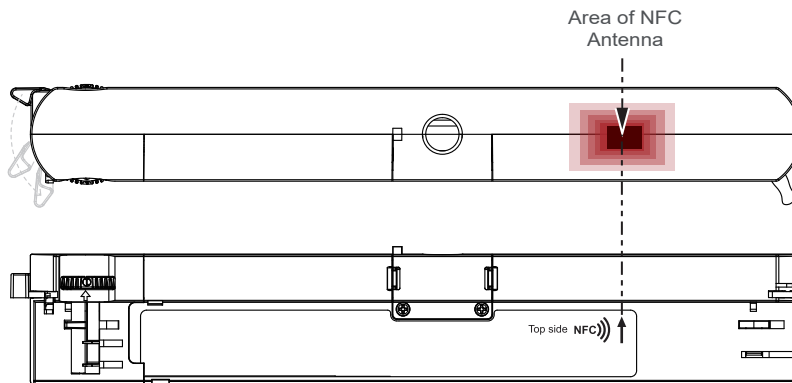

Lamp screw type

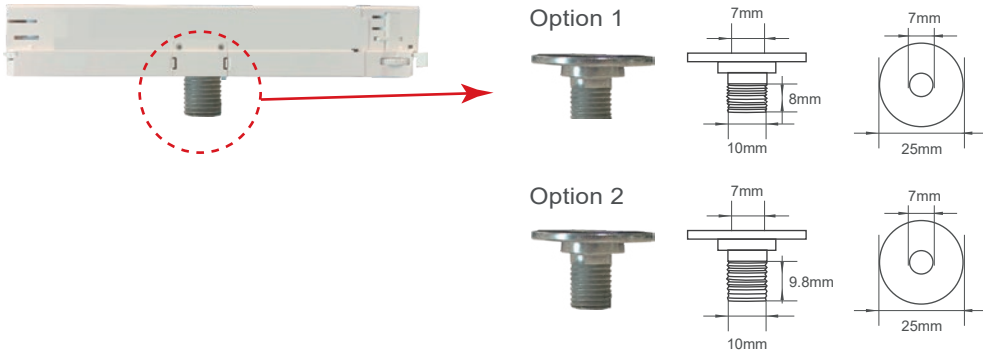

Load-bearing : 50N(11lbs)

The driver could be compatible with Global,Powergear,STUCCHI on 3-phase-circuit track system.

Manufacturer	Type	Model	System
NORDIC ALUMINIUM	Global Track pulse DALI	XTSC 6x00 XTSCF 6x00 x=1,2,3,4	3-phase + DALI
STUCCHI	Three-Phase Track + Control System	9000-.../...-ST 9000-.../...-R	3-phase + DALI
POWERGEAR	3 Circuits DALI Track System	PRO-06x0,06400 PRO-06x0,R6400 x=1,2,3	3-phase + DALI

MECHANICAL LOAD DIAGRAM

