



Approval Marks



- LWDC25W600NLR-W
- LWDC25W600NLR-B
- LWDC25W600NLR-G



Item	Value	Remark
Nominal voltage	220–240V	
Nominal frequency	50–60Hz	
AC voltage range	198–264V	
DC voltage range (start)	NA	
DC voltage range (operation)	NA	
Nominal current	140mA	
Total Harmonic Distortion (THD)	< 10%	Full load @230VAC
Power factor	0.3C-0.97	Min-load @ 240Vac and Full-load @ 220 Vac
Displacement factor	0.3C-0.97	Min-load @ 240Vac and Full-load @ 220 Vac
Efficiency	85%(Typ.)	Full load @230VAC
No-load power	NA	
Stand-by power	< 0.5W	
Protection class	II	
Inrush current	15 A / 20 us	
Max.units per circuit breaker	Type B , 10A MCB	29
	Type B , 16A MCB	46
	Type C , 10A MCB	36
	Type C , 16A MCB	57
Earth leakage current	NA	
Output	Nominal voltage range	
	120mA	15-54 Vdc
	150mA	15-54 Vdc
	200mA	10-54 Vdc
	250mA	10-54 Vdc
	300mA	10-54 Vdc
	350mA	10-54 Vdc
	450mA	10-54 Vdc
	500mA	10-50 Vdc
	600mA	10-42 Vdc
Maximum voltage	60 Vdc	
Nominal current range	120-600mA	DC Output with adjustable constant current from 120 to 600 mA via NFC in 1mA steps
Current accuracy	± 5%	
Typical output LF current ripple	± 5%	Low Frequency< 120Hz Full load @230VAC

	Item	Value	Remark
Output	Starting time	< 0.5 S	Full load @230VAC
	SVM	≤ 0.4	Full load @230VAC
	P _{stLM}	≤ 1	Full load @230VAC
	Nominal power range	1.8-25W	
	Maximum power	26W	
Dimming	Dimming control	DALI/Touch Dim	
	Dimming range	1-100%	
	Lowest dimming current	0.5%-4.5%	Full Operating Range, Check attached table
	Dimming technique	Amplitude	
	PWM frequency	NA	
	Galvanic isolation	Basic insulated to PRI and double insulated to SEC	
Environment	Ambient temperature range t _a	-20°C - +35°C	
	Maximum case temperature t _c	70°C	
	Max. case temp. in fault condition	110°C	When operating under fault conditions, the temperature of the enclosure at any location should not exceed 110 °C
	Storage temperature range	-40°C - +85°C	
	Relative humidity	10% - 95%	
	Surge transient protection	1 kV	L/N
	Environmental rating	Indoor	
	IP rating	IP20	
	Mains switching cycles	>100,000	
	Expected lifetime	> 50,000 h, t _c 70 °C @ t _a 35 °C	0.2 % / 1,000 h failure rate
	Packing	Gross weight/box	6.3 kg
Net weight/box		5.3 kg	
Pcs/box		35 PCS	
Dimension/box		385(L)*310(W)*260(H)mm	
Protections			
	Short-circuit Protection	Auto recovery	
	Open-circuit Protection	Auto recovery	
	Overload Protection	Auto recovery	
Conformity & Standards			
	Safety standard:	EN 61347-1, EN 61347-2-13, EN 62493	
	Performance:	EN 62384	
	EMC standard:	EN 55015, EN 61000-3-2, EN 61000-3-3, EN 61547	
	SAA standard:	AS/NZS 61347.1, AS 61347.2.13	
	DALI protocol standard:	EN 62386-101, EN 62386-102, EN 62386-207	
Cable information			
SEC	+	-	
Cable cross-section	0.34-0.5□/AWG 22-20	0.34-0.5□/AWG 22-20	
Stripping	9mm	9mm	
Terminal information			
PRI -Contact metal			
SEC -Push button/Angled Entry			
DALI -Contact metal			

* If not mentioned, all the test conditions are based on full load at 230VAC input (for 220-240 VAC input).

Subject to change without notice, HEP guarantees all products perform functionally well

Current adjustable

NFC Reader (optional)

Feature:

Easily on-line read a output current from a driver or write a new current data to a driver throughout HEP NFC reader within few seconds.



APP NFC

Feature:

Quickly check output current of a LED driver simply via Android smart phone, as well as, correct or setup a new current data immediately with no extra equipment at any job site.

ICON



Main



QR Code

Google play

APK



Android 6.0 Up

Smart phone with a NFC function

Electrical Values

Output Power Range

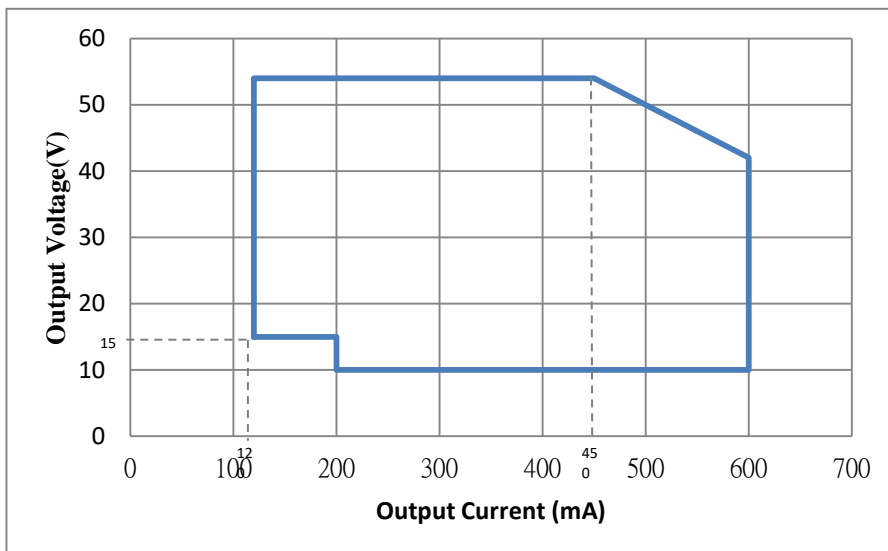

Output Current (mA)	Output Voltage Range (V)	Output Power Range (W)	Dimming Range (%)
600	10-42	6.0-25.2	1-100
500	10-50	5.0-25.0	1-100
450	10-54	4.5-24.3	1-100
350	10-54	3.5-18.9	1.2-100
300	10-54	3.0-16.2	1.4-100
250	10-54	2.5-13.5	1.6-100
200	10-54	2.0-10.8	2.0-100
150	15-54	2.3-8.1	2.8-100
120	15-54	1.8-6.48	3.5-100

* Upon client's special demand, customized current range in between 120 mA and 600 mA could be specified as factory default from shipment. This default current range available revised again via NFC reader program at client's site, if necessary.

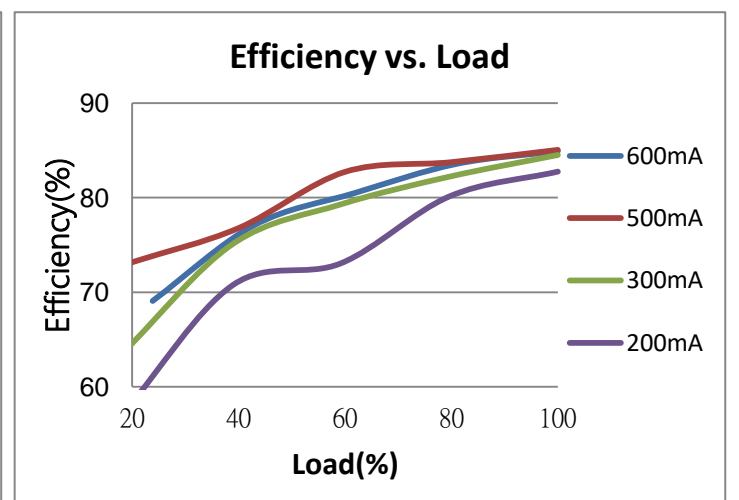
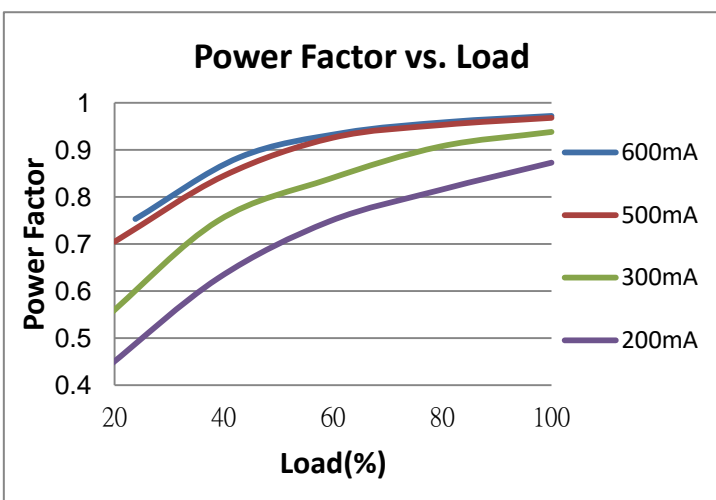
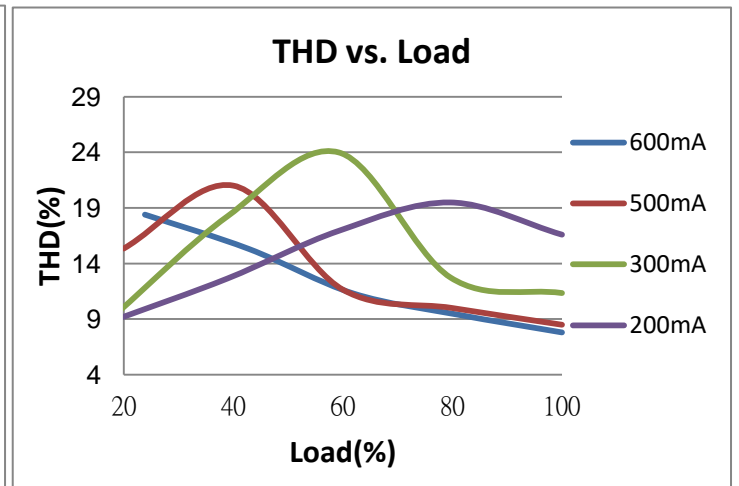
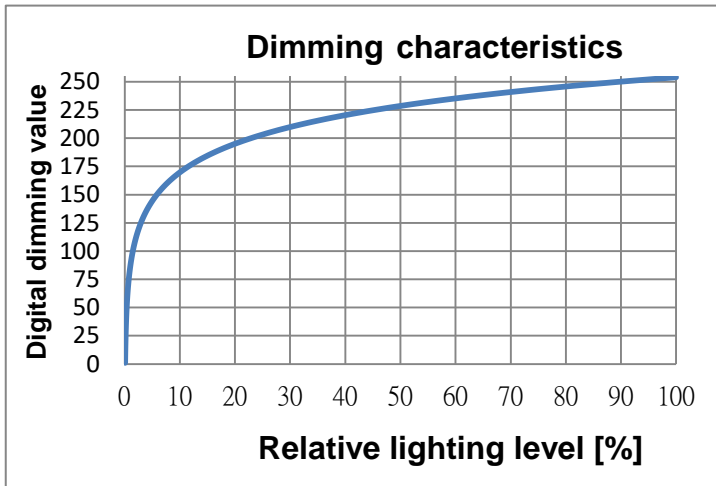

Label

<p>HEP GROUP® HEP GmbH - Ramsloh 10 58579 Schalksmuehle - Germany UN= 220-240V IN= 140mA max. $\lambda = 0.3C-0.97$ fN= 50-60Hz ta= -20°C - +35°C</p>	<p>DALI LED Driver LWDC25W600NLR</p>	<p>SEC SELV</p> <p>GMA-513600</p> <p>05 CE UK CA</p> <p>Top side NFC</p> <p>9mm wire preparation</p> <p>0.34-0.5 IAWG 22-20</p>
	<p>Urang= 10-54 Vdc Irated= 120-600mA const. Prated= 1.8-25W max. ratings Uout= 60V max. for output details see datasheet</p>	

Physical
Parameter

L : 255.0 mm W1 : 33.0 mm
 W : 31.0 mm W2 : 41.5 mm
 H : 45.9 mm H1 : 43.4 mm
 N : 13.7 mm M : 136.2 mm
 K : 27.5 mm

Tolerance : $\geq \pm 1$ mm
 Housing Material : Polycarbonate

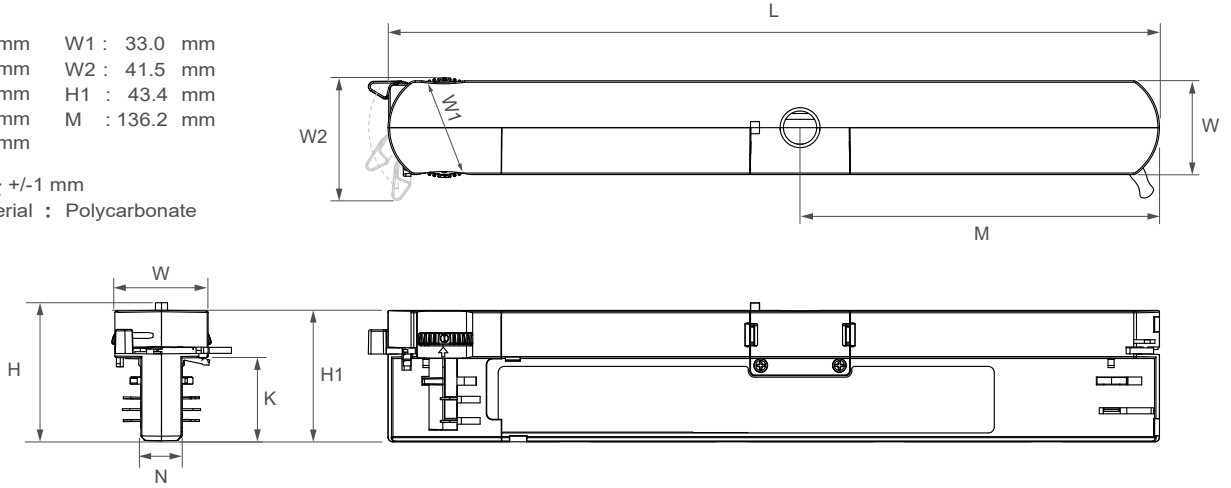

Wiring Diagram
DALI

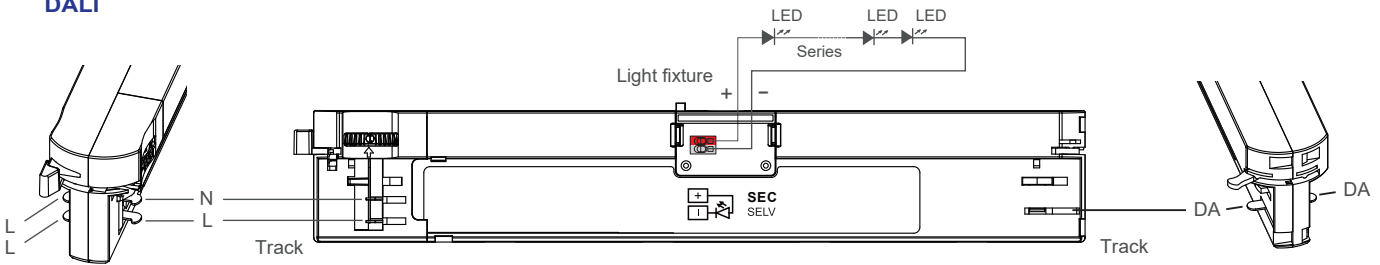

Touch Dim

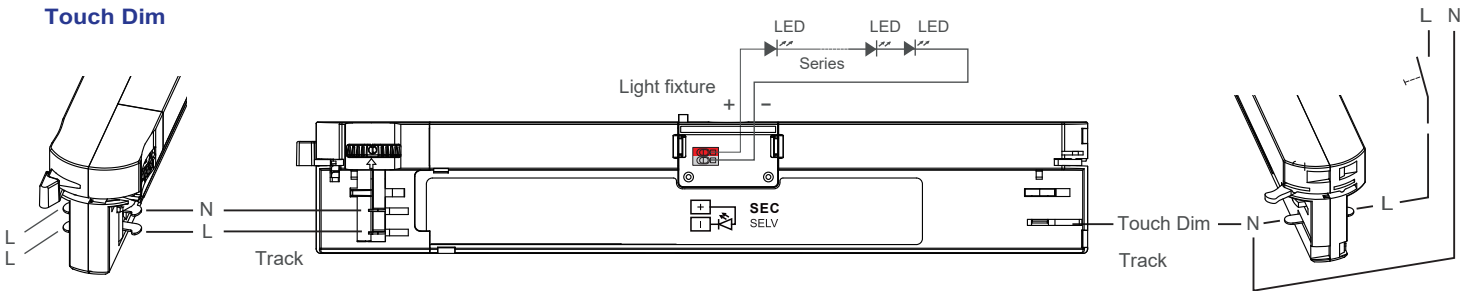

NFC Antenna Location

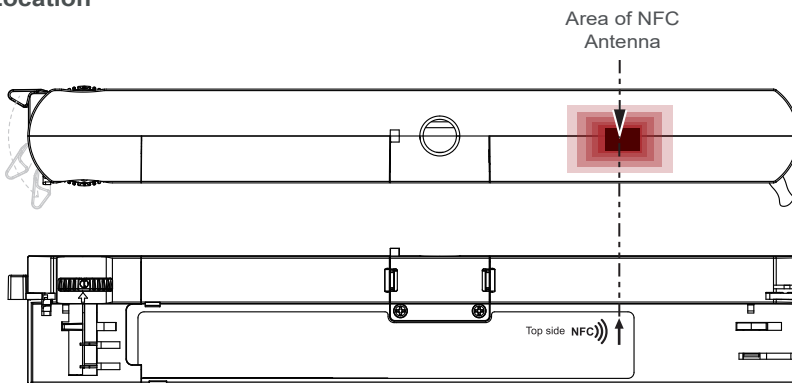

Lamp screw type

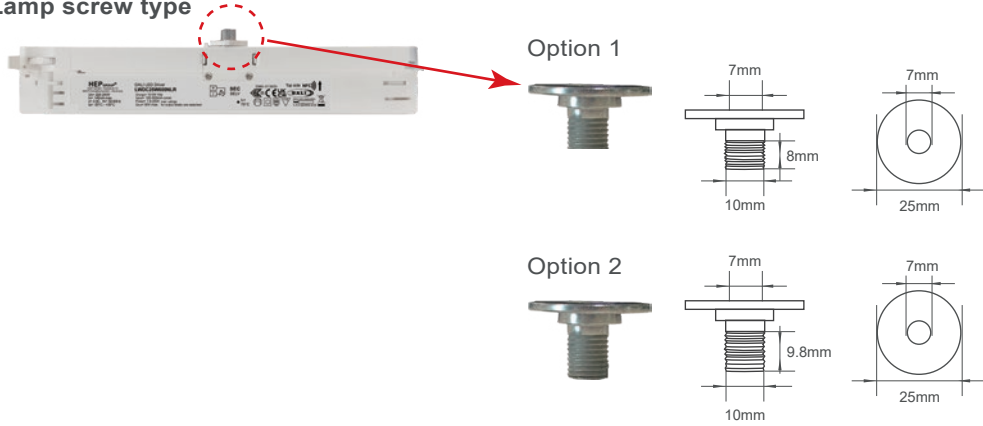

Load-bearing : 50N(11lbs)

The driver could be compatible with Global, Powergear, STUCCHI on 3-phase-circuit track system.

Manufacturer	Type	Model	System
NORDIC ALUMINIUM	Global Track pulse DALI	XTSC 6x00 XTSCF 6x00 x=1,2,3,4	3-phase + DALI
STUCCHI	Three-Phase Track + Control System	9000-.../...-ST 9000-.../...-R	3-phase + DALI
POWERGEAR	3 Circuits DALI Track System	PRO-06x0,06400 PRO-06x0,R6400 x=1,2,3	3-phase + DALI

MECHANICAL LOAD DIAGRAM

