

	Item	Value	Remark
Input	Nominal voltage	220–240V	
	Nominal frequency	50–60Hz	
	AC voltage range	198–264V	
	DC voltage range (start)	NA	
	DC voltage range (operation)	NA	
	Nominal current	107mA	Full load @230VAC
	Total Harmonic Distortion (THD)	< 10%	Full load @230VAC
	Power factor	0.9C	Full load @230VAC
	Displacement factor	0.9C	Full load @230VAC
	Efficiency	83% (Typ.)	Full load @230VAC
	No-load power	N/A	
	Stand-by power	<0.5W	
	Protection class	N/A	
	Inrush current	9A / 50us	Full load @240VAC
	Earth leakage current	NA	
Output	Nominal voltage range	20-40 Vdc	
	Maximum voltage	50Vdc	
	Nominal current range	500mA	
	Current accuracy	± 5%	Full load @230VAC
	Typical output LF current ripple	± 5%	Low Frequency< 120Hz Full load @230VAC
	Nominal power range	10-20W	
	Maximum power	20W	
Dimming	Dimming control	Wireless	
	Dimming technique	NA	
	PWM frequency	NA	
	Dimming range	1 -100%	
	Lowest dimming current	NA	
	Galvanic isolation	Basic insulated to PRI and supplementary insulated to SEC	

Item	Value	Remark
Ambient temperature range t _a	-20°C - +60°C	
Maximum case temperature t _c	90°C	
Max. case temp. in fault condition	110°C	When operating under fault conditions, the temperature of the enclosure at any location should not exceed 110 °C
Storage temperature range	-40°C - +85°C	
Relative humidity	10% - 95%	
Surge transient protection	1 kV	L/N
Environmental rating	Indoor	
IP rating	IP20	
Mains switching cycles	> 100,000	
Expected lifetime		
Output load 20W	> 70,000 h, tc85 °C @ ta 50 °C	0.14 % / 1,000 h failure rate
	> 40,000 h, tc90 °C @ ta 60 °C	0.25 % / 1,000 h failure rate
Packing	Gross weight/box	kg
	Net weight/box	kg
	Pcs/box	72 PCS
	Dimension/box	490(L)*270(W)*225(H)mm
Protections		
Short- & open circuit proof, Auto, Overload protection		
Conformity & Standards		
Safety standard:	EN 61347-1, EN 61347-2-13, EN 62493	
Performance:	EN 62384	
EMC standard:	EN 55015, EN 61000-3-2, EN 61000-3-3, EN 61547	
Cable information		
PRI Connection	L	N
Color	Brown	Blue
Wire type	7022	7022
Wire diameter	AWG18	AWG18
Wire length	130mm	130mm
Stripping	6mm	6mm
Tolerance	±5mm	±5mm
Sec Connection	+	-
Color	Red	Black
Wire type	3385	3385
Wire diameter	AWG22	AWG22
Wire length	115mm	115mm
Strip length	6mm	6mm
Tolerance	±5mm	±5mm

* If not mentioned, all the test conditions are based on full load at 230VAC input (for 220-240 VAC input).

Subject to change without notice, HEP guarantees all products perform functionally well

■ Specification of wireless module



Item	Value
Wireless protocol	Compliance with Bluetooth version 4.2 and above
Operating Frequency	2.4G~2.45 GHz
Antenna	Onboard chip antenna
Transmission Range	>20M (open site)
Power Supply	DC3.3V~3.6V
Operating Environment	-40~+45 °C
Dimension	Case:43(L)x31(W)x12(H)mm
	lead length: mm

■ Remote Control (optional)

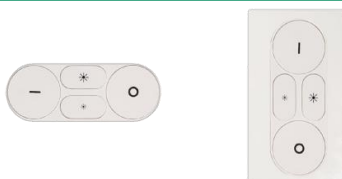

Model : BR-4K

Wireless protocol	Compliance with BLE version 4.2 and above
Operating frequency	2.4G~2.485 GHz
Antenna	Module Chips Antenna
Transmission distance	10-15M
Power consumption	Stand-by mode : 0.03W
	Operation mode:10A
Power supply	1 x CR2450 3Vdc battery
Operating environment	-0~+45 °C , 5~80% RH
Material	ABS
Dimension	95mm(L)x35mm(W)x12mm(H) Wall Panel120mm(L)x70mm(W)x16.3mm(H)

■ Lighting Control APP

APP(HEPxIDEA)

Working via WBDA freely control lights to dim up or down,
tune warm or cool color by just using a smart phone.

Android

iOS

ICON

Main



OS Version : Android 5.0 Up, iOS 10.3 Up

Mesh function

- 1.Mesh Network totally connecting up to 250 devices
- 2.All devices grouping to 16 groups maximumly
- 3.A group added in total of 30 devices
- 4.A device joined to 8 different groups overall
- 5.Timer preset 4 types of schedule onto individual device and groups as well
- 6.Maximum 5 scenes available to be determined

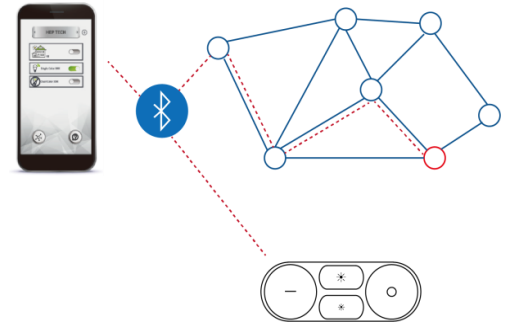

Remote Control

- 1.Perfectly operate HEP wireless LED drivers on diming up/down or tuning color temperature
- 2.Work in conjunction with APP HEPxIDEAL to functionally manage lighting on individual or group control
- 3.Slim and elegant design in form factor with ultra light weight of 90 grams
- 4.Firmly fixed on and easily taken apart from magnetic wall panel for use convenience
- 5.Long transmission distance of 10~15 meters in controlling luminaires

Electrical Values

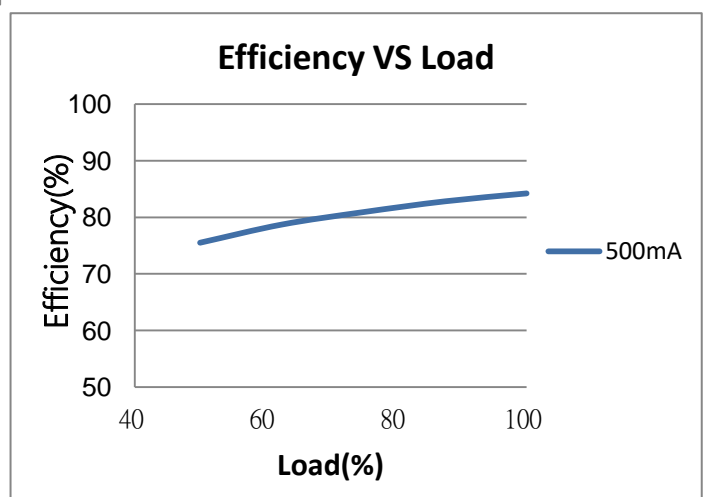
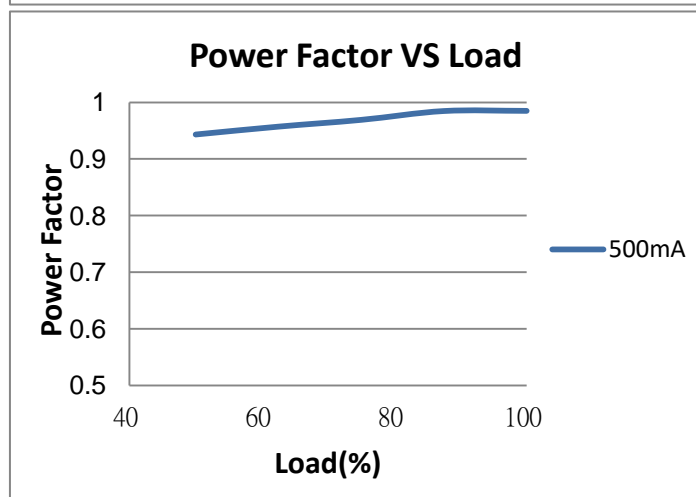
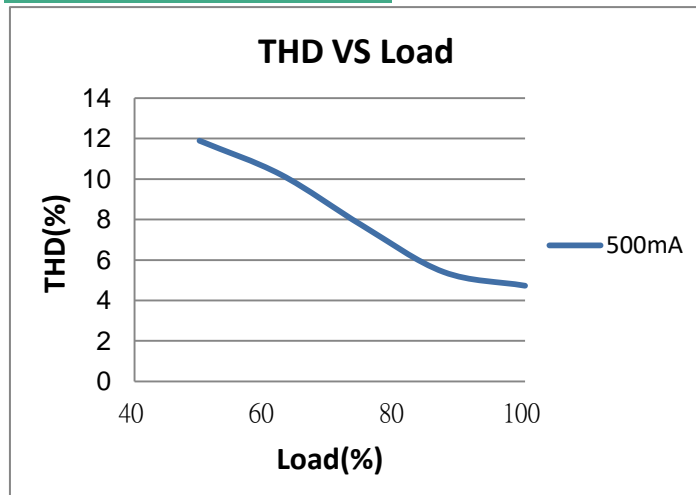

Physical

Parameter

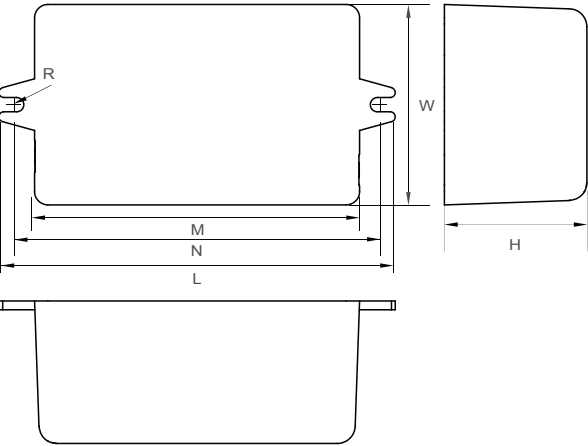

L : 89 mm N : 81 mm H : 32 mm
M : 73 mm W : 45 mm R : 1.6 mm
Housing Material : Polycarbonate / Potting
Soldering : Lead-Free, Comply With RoHS
Label : Surface Print

Wiring Diagram

