

Electronic Ballast For HID Lamps

220-240V



Approval Marks



Product Specification

| Parameter | Conditions | Min | Nom | Max | Unit |
|--|----------------------------------|--------|-------|-------|-------|
| Lamp Power | 25°C, Nominal Input | - | 39 | - | W |
| Input Power | 25°C, Nominal Input | - | 44.5 | - | W |
| Rated Input Voltage | 25°C | 220 | 230 | 240 | V |
| AC Input Voltage Range with Tolerance For Safety | 25°C | 198 | - | 264 | V |
| Input Frequency | 25°C | - | 50-60 | - | Hz |
| Input Current | 25°C, Nominal Input | - | 0.2 | - | A |
| Power Factor | 25°C, Nominal Input | 0.93 | 0.95 | 1 | - |
| Operating Frequency(Square Wave) | 25°C, Nominal Input | - | 200 | - | Hz |
| Ignition Voltage | 25°C, Nominal Input | - | 3.50 | 5.00 | KV |
| Withstand Voltage Test | 1500V; 1min | - | 5 | - | mA |
| Operating Ambient Temperature | Nominal Input | -15 | - | +50 | degC |
| Max Allowed Case Temperature | Nominal Input; Normal Conditions | - | - | +70 | degC |
| Average Service Life | at 50°C ambient | 35,000 | - | - | hours |
| Failure Rate Per 1000h Operation | at 50°C ambient | - | - | 0.20% | - |
| End - Of - Life Protection | | | Yes | | |
| Automatic Shutdown In Case Of Lamp Failure | | | Yes | | |
| Thermal Protection | | | Yes | | |

Lamp Type HID 35W Lamp x 1

Application Space

Indoor Use
(Low Humidity, No Condensation)

Physical

Parameter

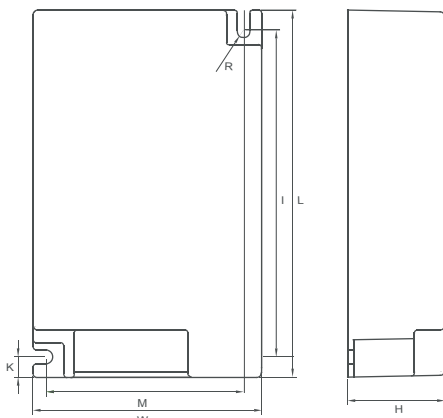

L : 108.9 mm K : 6 mm
 M : 65 mm R : 2.1 mm
 W : 75.4 mm I : 97 mm
 H : 32 mm
 Slot On One Side Allowing Alignment : M+/-3 mm
 Tolerance : ≥0 ~ 100 ≥ +/-0.5 mm
 100 ~ ≥ +/-1 mm

Terminal Block : PRI : Screw Type SEC : Screw Type
 Housing Material : Plastic, No sharp edges
 Soldering : Lead-Free, Comply With RoHS
 Label : Surface Print

Wiring Diagram

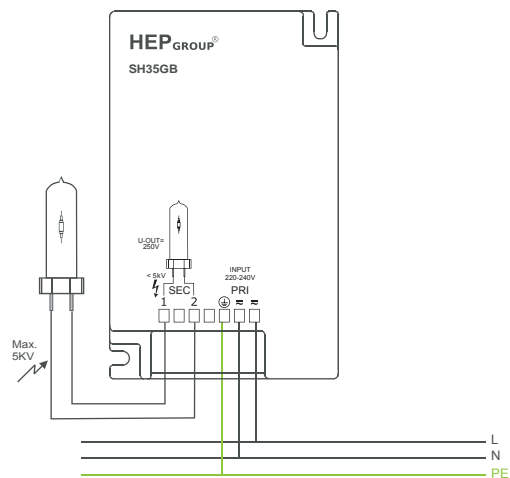

6KVAC 18 AWG High-voltage sustained cable