



Approval Marks



- LWC40W1050CALR-W
- LWC40W1050CALR-B
- LWC40W1050CALR-G

	Item	Value	Remark
Input	Nominal voltage	220–240V	
	Nominal frequency	50–60Hz	
	AC voltage range	198–264V	
	DC voltage range (start)	NA	
	DC voltage range (operation)	NA	
	Nominal current	230mA	
	Total Harmonic Distortion (THD)	< 15%	Full load @230VAC
	Power factor	0.96	Full load @230VAC
	Displacement factor	0.96	Full load @230VAC
	Efficiency	86%(Typ.)	Full load @230VAC
	No-load power	NA	
	Stand-by power	NA	
	Protection class	II	Suitable for class II luminaires
	Inrush current	12 A / 30 μ s	
	Earth leakage current	NA	
Output	Nominal voltage range	25-38Vdc	
	Maximum voltage	55Vdc	
	Nominal current range		
	1050mA	1050mA	
	950mA	950mA	
	800mA	800mA	
	700mA	700mA	
	Current accuracy	\pm 5%	Full load @230VAC
	Typical output LF current ripple	\pm 5%	Low Frequency< 120Hz Full load @230VAC
	SVM	\leq 0.4	Full load @230VAC
	P _{stLM}	\leq 1	Full load @230VAC
	Starting time	< 0.5 S	Full load @230VAC
	Nominal power range		
	1050mA	26.3-39.9W	
	950mA	23.8-36.1W	
800mA	20-30.4W		
700mA	17.5-26.6W		
Maximum power	40W		

	Item	Value	Remark
Environment	Ambient temperature range t_a	-10°C - +35°C	
	Maximum case temperature t_c	75°C	
	Max. case temp. in fault condition	110°C	When operating under fault conditions, the temperature of the enclosure at any location should not exceed 110 °C
	Storage temperature range	-40°C - +85°C	
	Relative humidity	10% - 90%	
	Surge transient protection	1 kV	L/N
	Environmental rating	Indoor	
	IP rating	IP20	
	Mains switching cycles	> 100,000	
	Expected lifetime	> 50,000 h, t_c 75 °C @ t_a 35 °C > 100,000 h, t_c 65 °C @ t_a 25 °C	0.2 % / 1,000 h failure rate 0.1 % / 1,000 h failure rate
Packing	Gross weight/Carton	5.8 kg	
	Net weight/Carton	4.9 kg	
	Pcs/Carton	35 PCS	
	Dimension/Carton	385(L)*310(W)*260(H)mm	

Protections

Short- & open circuit proof, Auto. Overload protection

Conformity & Standards

Safety standard:	EN 61347-1, EN 61347-2-13, EN 62493
Performance:	EN 62384
EMC standard:	EN 55015, EN 61000-3-2, EN 61000-3-3, EN 61547

Cable information

Sec Connection	+	-
Cable cross-section	0.34-0.5□/AWG 22-20	0.34-0.5□/AWG 22-20
Stripping	9mm	9mm

Terminal information

PRI-Contact metal

SEC-Push button/Angled Entry

* If not mentioned, all the test conditions are based on full load at 230VAC input (for 220-240 VAC input).

Subject to change without notice, HEP guarantees all products perform functionally well

Electrical Values

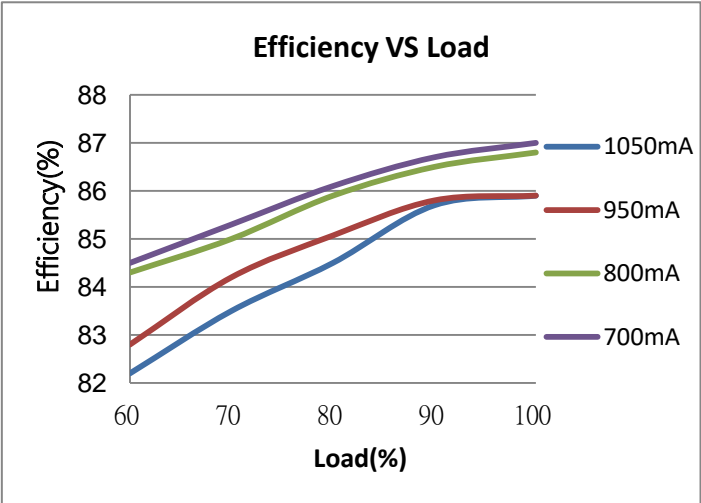
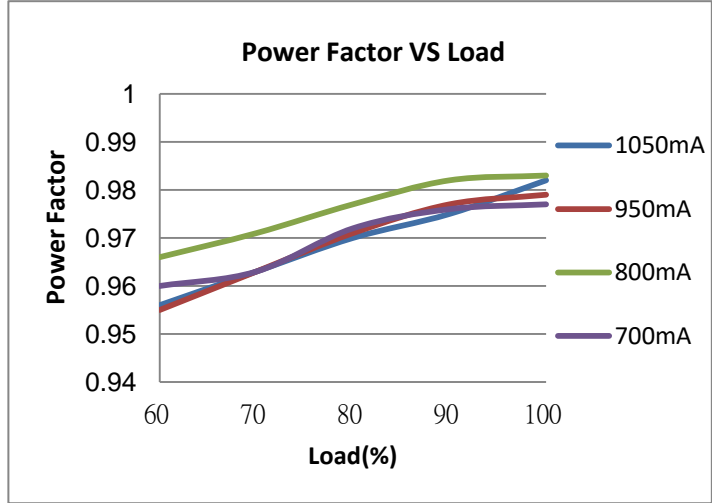
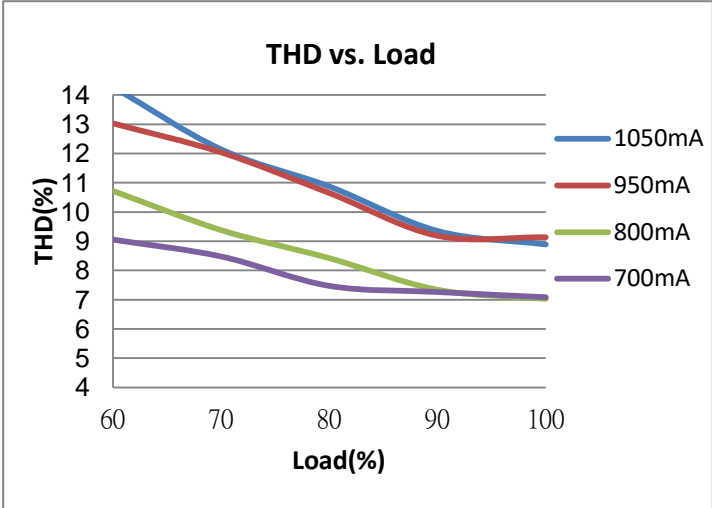

Label

HEP GROUP® HEP GmbH - Ramsloh 10 58579 Schalksmühle - Germany UN= 220-240Vac IN= 230mA max. λ= 0.96 f _n = 50-60Hz ta= -20°C - +35°C	LED Driver	DIP 	+ 	SEC SELV		
	LWC40W1050CALR					U _{range} = 25-38Vdc
	I _{rated} = 700-1050mA const.					Prated= 17.5-39.9W max. ratings
	U _{out} = 55V max.					for output details see datasheet

I _{rated} (mA)	DIP1	DIP2
700	OFF	OFF
800	ON	OFF
950	OFF	ON
1050	ON	ON

tc= 75°C

9mm wire preparation
0.34-0.5 / AWG 22-20

Physical

Parameter

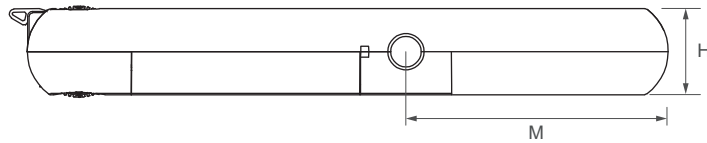
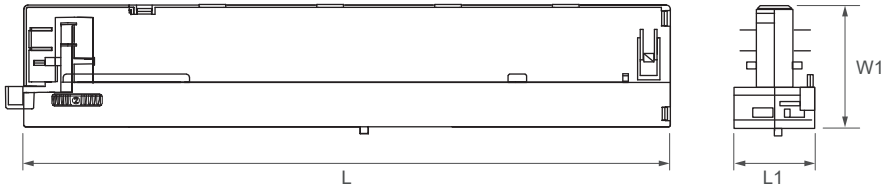

L : 230.5 mm H : 31 mm
 M : 94.3 mm W : 45.9 mm
 L1 : 31 mm W1 : 45.9 mm
 Tolerance : ≥ +/-1 mm

Wiring Diagram

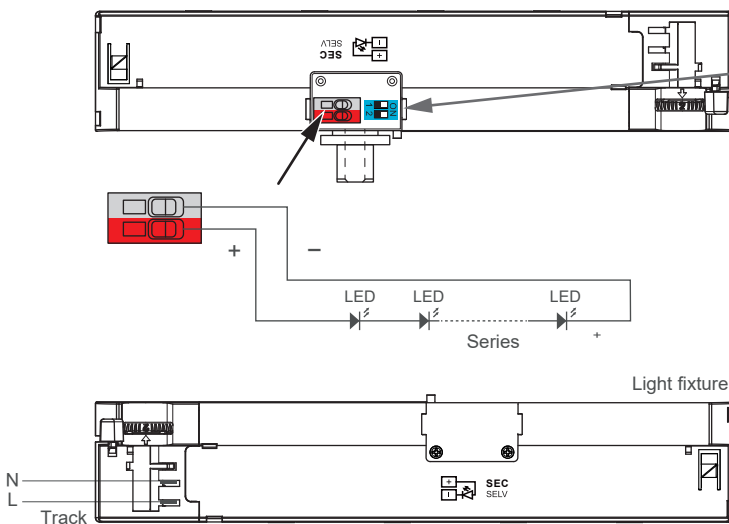

Dip Switch - One driver offers 4 choosable output current



700mA / 800mA / 900 mA / 1050 mA

Current	Micro-switch setting	
	1	2
700mA	-	-
800mA	ON	-
900mA	-	ON
1050mA	ON	ON

Lamp screw type

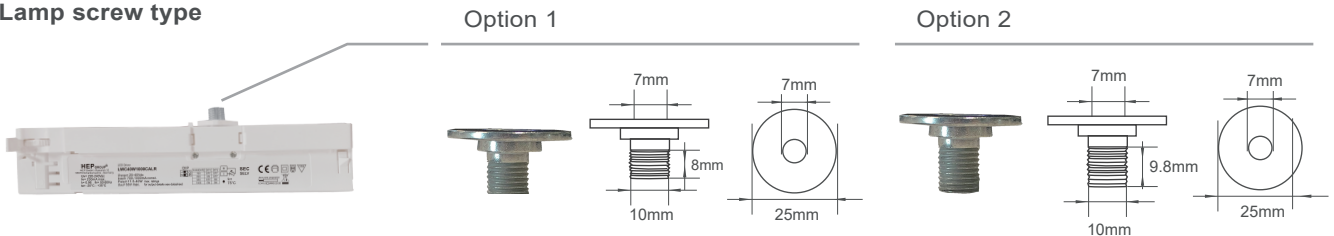

The driver could be compatible with Global, Powergear, STUCCHI on 3-phase-circuit track system.

Manufacturer	Type	Model	System
NORDIC ALUMINIUM	Global Track Pro	XTS 4x00 x=1,2,3,4	3-phase
EUTRAC	Surface Track	25-x0 x=1,2,3,4	3-phase
ZUMTOBEL	3 Circuits DALI Track System	S2 801 S2 803	3-phase
IVELA	3-phase LKM	7501-x0 x=1,2,3,4	3-phase
POWERGEAR	3 Circuits Track System	PRO-04x0 x=1,2,3	3-phase