

Approval Marks

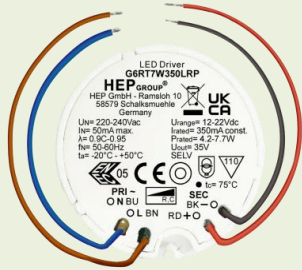

Item	Value	Remark
Nominal voltage	220–240V	
Nominal frequency	50–60Hz	
AC voltage range	198–264V	
DC voltage range (start)	NA	
DC voltage range (operation)	NA	
Nominal current	50mA	Full load @230VAC
Total Harmonic Distortion (THD)	< 20%	Full load @230VAC
Power factor	0.9C-0.95	Full load @230VAC
Displacement factor	0.9C-0.95	Full load @230VAC
Efficiency		Full load @230VAC
Input	G6RT7W150LRP	80%(Typ.)
	G6RT7W350LRP	77%(Typ.)
	G6RT7W500LRP	74%(Typ.)
	G6RT7W700LRP	70%(Typ.)
	No-load power	NA
Stand-by power	NA	
Protection class	NA	Suitable for class II luminaires
Inrush current	3.5A / 120us	
Max.units per circuit breaker	Type B , 10A MCB	80
	Type B , 16A MCB	128
	Type C , 10A MCB	100
	Type C , 16A MCB	160
Earth leakage current	NA	
Output	Nominal voltage range	
	G6RT7W150LRP	30-42Vdc
	G6RT7W350LRP	12-22Vdc
	G6RT7W500LRP	9-13Vdc
	G6RT7W700LRP	6-9Vdc
	Maximum voltage	
	G6RT7W150LRP	50Vdc
	G6RT7W350LRP	35Vdc
	G6RT7W500LRP	25Vdc
G6RT7W700LRP	20Vdc	

	Item	Value	Remark
Output	Nominal current range		Full load @230VAC
	G6RT7W150LRP	150mA	
	G6RT7W350LRP	350mA	
	G6RT7W500LRP	500mA	
	G6RT7W700LRP	700mA	
	Current accuracy		Full load @230VAC
	G6RT7W350/500/700LRP	± 5%	
	G6RT7W150LRP	± 7%	
	Typical output LF current ripple	± 5%	Low Frequency < 120Hz Full load @230VAC
	Starting time	< 0.5 S	Full load @230VAC
	SVM	≤0.4	Full load @230VAC
	PstLM	≤1	Full load @230VAC
	Nominal power range		
	G6RT7W150LRP	4.5-6.3W	
G6RT7W350LRP	4.2-7.7W		
G6RT7W500LRP	4.5-6.5W		
G6RT7W700LRP	4.2-6.3W		
Maximum power	7.7W		
Dimming	Dimming control	Trailing edge	
	Dimming range	10-100%	
	Lowest dimming current	2-6%	
	Dimming technique	Amplitude	
	PWM frequency	NA	
	Galvanic isolation	NA	
Environment	Ambient temperature range t_a	-20°C - +50°C	
	Maximum case temperature t_c		
	G6RT7W150LRP	70°C	
	G6RT7W350LRP	75°C	
	G6RT7W500LRP	75°C	
	G6RT7W700LRP	85°C	
	Max. case temp. in fault condition	110°C	When operating under fault conditions, the temperature of the enclosure at any location should not exceed 110 °C
	Storage temperature range	-40°C - +85°C	
	Relative humidity	10% - 90%	
	Surge transient protection	1 kV	L/N
	Environmental rating	Indoor	
	IP rating	IP20	
Mains switching cycles	> 100,000		
Expected lifetime			
G6RT7W150LRP	Full load	> 50,000 h, t_c 70 °C @ t_a 50 °C	0.2 % / 1,000 h failure rate
	Output load \leq 4.9W	> 48,000 h, t_c 70 °C @ t_a 60 °C	0.21 % / 1,000 h failure rate
G6RT7W350LRP	Full load	> 50,000 h, t_c 75 °C @ t_a 50 °C	0.2 % / 1,000 h failure rate
	Output load \leq 4.9W	> 48,000 h, t_c 75 °C @ t_a 60 °C	0.21 % / 1,000 h failure rate
G6RT7W500LRP	Full load	> 50,000 h, t_c 75 °C @ t_a 50 °C	0.2 % / 1,000 h failure rate
	Output load \leq 4.9W	> 48,000 h, t_c 75 °C @ t_a 60 °C	0.21 % / 1,000 h failure rate
G6RT7W700LRP	Full load	> 50,000 h, t_c 85 °C @ t_a 50 °C	0.2 % / 1,000 h failure rate
	Output load \leq 4.9W	> 48,000 h, t_c 85 °C @ t_a 60 °C	0.21 % / 1,000 h failure rate

Packing	Gross weight/Carton	3.8 kg
	Net weight/Carton	3.4 kg
	Pcs/Carton	90 PCS
	Dimension/Carton	240(L)*190(W)*185(H)mm

Protections

Short-circuit Protection	Auto recovery
Open-circuit Protection	Auto recovery
Overload Protection	Auto recovery

Conformity & Standards

Safety standard:	EN 61347-1, EN 61347-2-13, EN 62493
Performance:	EN 62384
EMC standard:	EN 55015, EN 61000-3-2, EN 61000-3-3, EN 61547

Cable information

PRI	Connection	L	N
	Color	Brown	Blue
	Wire type	7022	7022
	Wire diameter	AWG20	AWG20
	Wire length	140mm	140mm
	Stripping	6mm	6mm
	Tolerance	±5mm	±5mm

SEC	Connection	+	-
	Color	Red	Black
	Wire type	1332	1332
	Wire diameter	AWG22	AWG22
	Wire length	139mm	139mm
	Stripping	6mm	6mm
	Tolerance	±5mm	±5mm

Subject to change without notice, HEP guarantees all products perform functionally well

* If not mentioned, all the test conditions are based on full load at 230VAC input (for 220-240 VAC input).

Trailing Edge Dimmer list approved by HEP

Manufacturer	Model	Q'ty of parallelconnection
Philips	SED-200A	20
Schneider	SBD315RC	30
Etman	ETM327	40
Etman	ETM329	40
Merten	SBD200LED	40
Busch	6513 U-102	40
Busch	6523 UR-103	40
Busch	6523 U-102	25
Niko	310-0190X	32
JUNG	LB-Management	40
CASAMBI	CBU-TED	15

Electrical Values

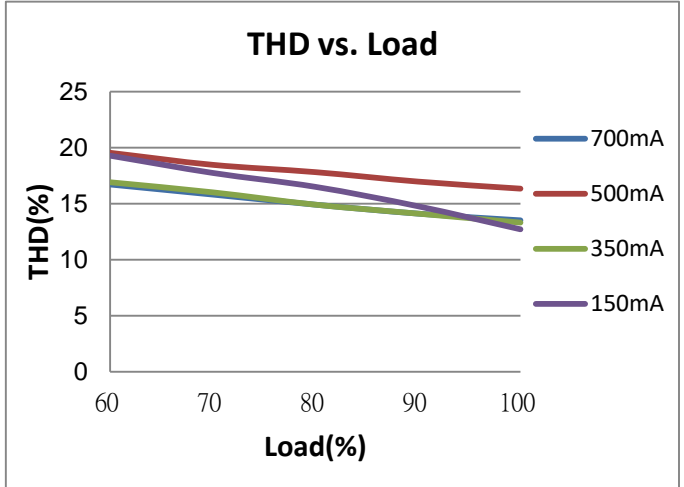
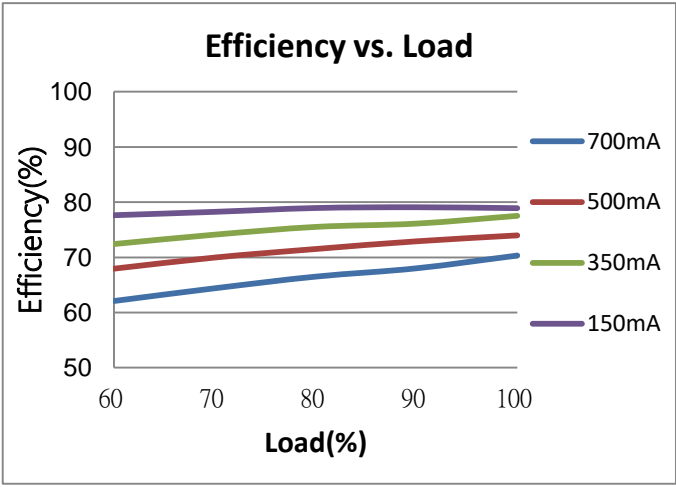
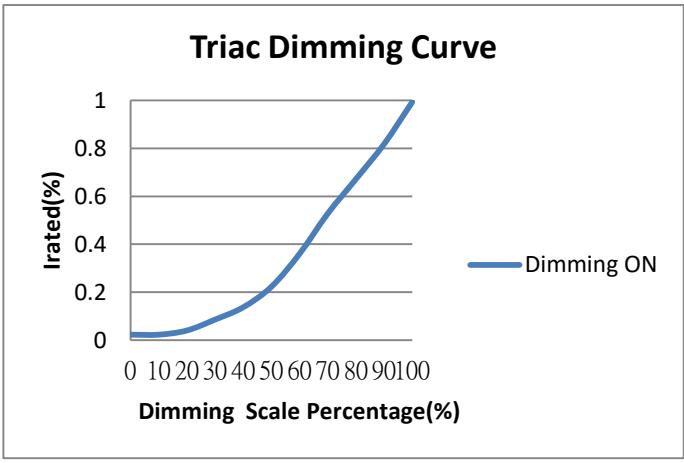
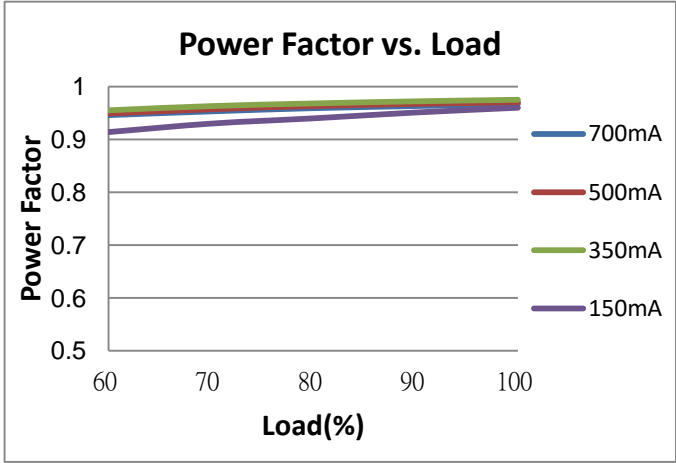

**Physical
Parameter**

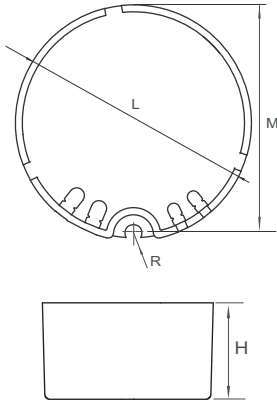

L : 44.3 mm M : 42.8 mm
 H : 25 mm R : 1.6 mm
 Tolerance : +/-1 mm , R : +/-0.5 mm

Housing Material : Polycarbonate / Potting
 Soldering : Lead-Free, Comply With RoHS
 Label : Surface Print

Wiring Diagram

