

Approval Marks

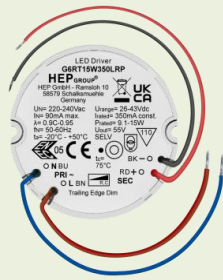

Item	Value	Remark
Nominal voltage	220–240V	
Nominal frequency	50–60Hz	
AC voltage range	198–264V	
DC voltage range (start)	NA	
DC voltage range (operation)	NA	
Nominal current	90mA	Full load @230VAC
Total Harmonic Distortion (THD)	< 23%	Full load @230VAC
Power factor	0.9C-0.95	Full load @230VAC
Displacement factor	0.9C-0.95	Full load @230VAC
Efficiency		Full load @230VAC
Input	G6RT15W300LRP	84%(Typ.)
	G6RT15W350LRP	84%(Typ.)
	G6RT15W500LRP	83%(Typ.)
	G6RT15W700LRP	82%(Typ.)
No-load power	NA	
Stand-by power	NA	
Protection class	NA	Suitable for class II luminaires
Inrush current	4A /35us	
Max.units per circuit breaker	Type B , 10A MCB	44
	Type B , 16A MCB	71
	Type C , 10A MCB	56
	Type C , 16A MCB	89
Earth leakage current	NA	
Output	Nominal voltage range	
	G6RT15W300LRP	26-43Vdc
	G6RT15W350LRP	26-43Vdc
	G6RT15W500LRP	18-30Vdc
	G6RT15W700LRP	13-21Vdc
	Maximum voltage	
	G6RT15W300LRP	55Vdc
	G6RT15W350LRP	55Vdc
	G6RT15W500LRP	38Vdc
	G6RT15W700LRP	33Vdc
Nominal current range		Full load @230VAC
G6RT15W300LRP	300mA	

	Item	Value	Remark
	G6RT15W350LRP	350mA	
	G6RT15W500LRP	500mA	
	G6RT15W700LRP	700mA	
Output	Current accuracy	± 5%	Full load @230VAC
	Typical output LF current ripple	± 5%	Low Frequency< 120Hz Full load @230VAC
	Starting time	< 0.5 S	Full load @230VAC
	SVM	≤0.4	Full load @230VAC
	PstLM	≤1	Full load @230VAC
	Nominal power range		
	G6RT15W300LRP	7.8-12.9W	
	G6RT15W350LRP	9.1-15W	
	G6RT15W500LRP	9-15W	
	G6RT15W700LRP	9.1-14.7W	
Maximum power	15W		
Dimming	Dimming control	Trailing edge	
	Dimming range	10-100%	
	Lowest dimming current	2-6%	
	Dimming technique	Amplitude	
	PWM frequency	NA	
	Galvanic isolation	NA	
Environment	Ambient temperature range t_a	-20°C - +50°C	
	Maximum case temperature t_c		
	G6RT15W300/350/500LRP	75°C	
	G6RT15W700LRP	80°C	
	Max. case temp. in fault condition	110°C	When operating under fault conditions, the temperature of the enclosure at any location should not exceed 110 °C
	Storage temperature range	-40°C - +85°C	
	Relative humidity	10% - 90%	
	Surge transient protection	1 kV	L/N
	Environmental rating	Indoor	
	IP rating	IP20	
	Mains switching cycles	> 100,000	
	Expected lifetime		
Packing	G6RT15W300/350/500LRP	Full load	> 50,000 h, t_c 75 °C @ t_a 50 °C 0.2 % / 1,000 h failure rate
		Output load ≤ 10.5W	> 48,000 h, t_c 75 °C @ t_a 60 °C 0.21 % / 1,000 h failure rate
	G6RT15W700LRP	Full load	> 50,000 h, t_c 80 °C @ t_a 50 °C 0.2 % / 1,000 h failure rate
		Output load ≤ 10.5W	> 48,000 h, t_c 80 °C @ t_a 60 °C 0.21 % / 1,000 h failure rate
Packing	Gross weight/Carton	14.2 kg	
	Net weight/Carton	13.2 kg	
	Pcs/Carton	180 PCS	
	Dimension/Carton	385(L)*310(W)*260(H)mm	
Protections			
Short-circuit Protection		Auto recovery	
Open-circuit Protection		Auto recovery	
Overload Protection		Auto recovery	
Conformity & Standards			
Safety standard:	EN 61347-1, EN 61347-2-13, EN 62493		
Performance:	EN 62384		
EMC standard:	EN 55015, EN 61000-3-2, EN 61000-3-3, EN 61547		

Cable information

PRI Connection	L	N
Color	Brown	Blue
Wire type	7022	7022
Wire diameter	AWG20	AWG20
Wire length	140mm	140mm
Stripping	6mm	6mm
Tolerance	±5mm	±5mm

SEC Connection	+	-
Color	Red	Black
Wire type	1332	1332
Wire diameter	AWG22	AWG22
Wire length	139mm	139mm
Stripping	6mm	6mm
Tolerance	±5mm	±5mm

Subject to change without notice, HEP guarantees all products perform functionally well

* If not mentioned, all the test conditions are based on full load at 230VAC input (for 220-240 VAC input).

Trailing Edge Dimmer list approved by HEP

Manufacturer	Model	Qty of parallel connection
Philips	SED-200A	10
Schneider	SBD315RC	15
Etman	ETM327	18
Etman	ETM329	18
Merten	SBD200LED	18
Busch	6513 U-102	19
Busch	6523 UR-103	18
Busch	6523 U-102	12
Niko	310-0190X	15
JUNG	LB-Management	18
CASAMBI	CBU-TED	7

Electrical Values

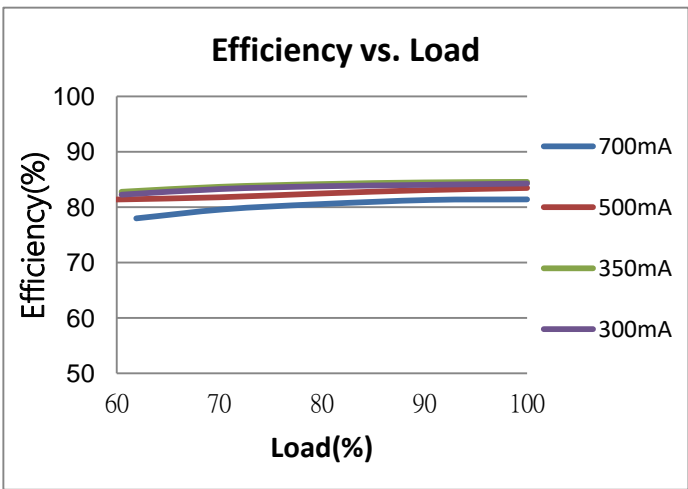
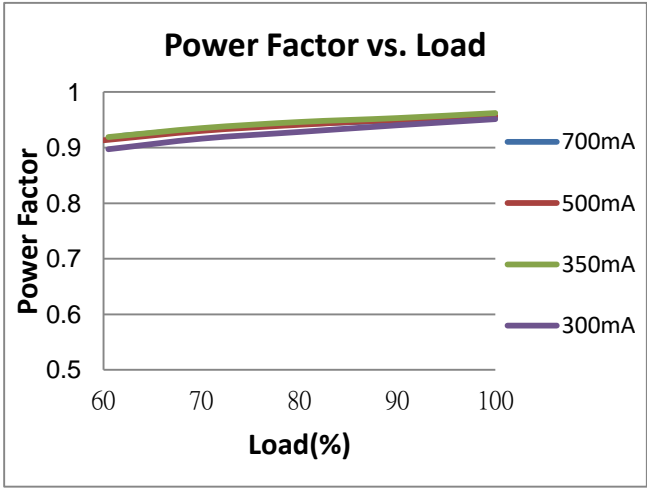
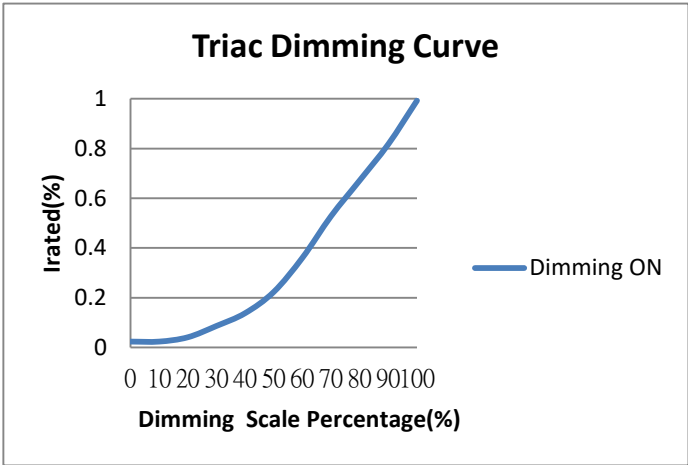
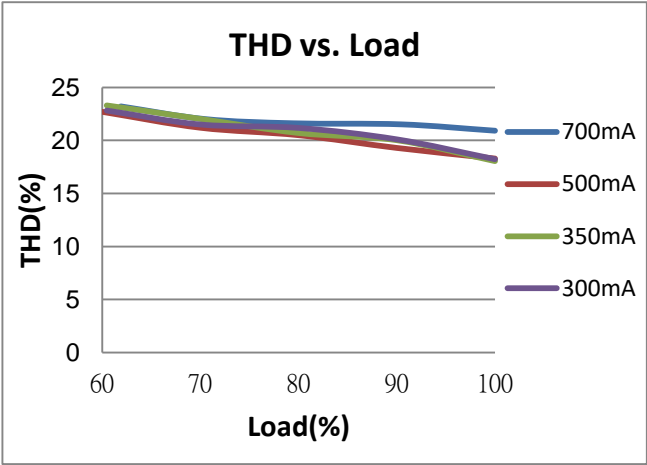

**Physical
Parameter**

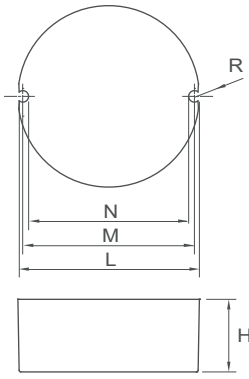

L : 48 mm M : 46.7 mm N : 43.5 mm

H : 25 mm R : 1.6 mm

Tolerance : +/-1 mm , R : +/-0.5 mm

Housing Material : Polycarbonate / Potting

Soldering : Lead-Free, Comply With RoHS

Label : Surface Print

Wiring Diagram

