

Approval Marks



| | Item | Value | Remark | |
|------------------|---------------------------------|------------------|---|--|
| | Nominal voltage | 220–240V | | |
| | Nominal frequency | 50–60Hz | | |
| | AC voltage range | 198–264V | | |
| | DC voltage range (start) | NA | | |
| | DC voltage range (operation) | NA | | |
| | Nominal current | | | |
| | G6R10W200LRP | 60mA | | |
| | G6R10W350/500/700LRP | 65mA | | |
| | G6R10W250/600LRP | 70mA | | |
| Input | Total Harmonic Distortion (THD) | <70 | Full load @230VAC | |
| | Power factor | 0.8-0.9C | Min-load @ 240Vac and Full-load @ 220 Vac | |
| | Displacement factor | 0.8-0.9C | Min-load @ 240Vac and Full-load @ 220 Vac | |
| | Efficiency | 81% (Typ.) | Full load @230VAC | |
| | No-load power | NA | | |
| | Stand-by power | NA | | |
| | Protection class | NA | | |
| | Inrush current | 6A / 20us | | |
| | Max.units per circuit breaker | Type B , 10A MCB | 57 | |
| | | Type B , 16A MCB | 91 | |
| Type C , 10A MCB | | 71 | | |
| Type C , 16A MCB | | 114 | | |
| | Earth leakage current | NA | | |
| Output | Nominal voltage range | | | |
| | G6R10W200/250LRP | 30-42Vdc | | |
| | G6R10W350LRP | 13-26Vdc | | |
| | G6R10W500LRP | 12-20Vdc | | |
| | G6R10W600LRP | 12-18Vdc | | |
| | G6R10W700LRP | 8.6-12.9Vdc | | |
| | Maximum voltage | | | |
| G6R10W200/250LRP | 65Vdc | | | |

| | Item | Value | Remark |
|-------------|------------------------------------|--------------------------------------|--|
| | G6R10W350LRP | 38Vdc | |
| | G6R10W500LRP | 28Vdc | |
| | G6R10W600LRP | 28Vdc | |
| | G6R10W700LRP | 25Vdc | |
| | Nominal current range | | |
| | G6R10W200LRP | 200mA | |
| | G6R10W250LRP | 250mA | |
| | G6R10W350LRP | 350mA | |
| | G6R10W500LRP | 500mA | |
| | G6R10W600LRP | 600mA | |
| | G6R10W700LRP | 700mA | |
| | Current accuracy | | |
| Output | G6R10W350/500/600/700LRP | ± 5% | Full load @230VAC |
| | G6R10W200/250LRP | ± 8% | Full load @230VAC |
| | Typical output LF current ripple | ± 5% | Low Frequency< 120Hz Full load @230VAC |
| | Starting time | < 0.5 S | Full load @230VAC |
| | SVM | ≤ 0.4 | |
| | PstLM | ≤ 1 | |
| | Nominal power range | | |
| | G6R10W200LRP | 6.0-8.4W | |
| | G6R10W250LRP | 7.5-10.5W | |
| | G6R10W350LRP | 4.6-9.1W | |
| | G6R10W500LRP | 6.0-10.0W | |
| | G6R10W600LRP | 7.2-10.8W | |
| | G6R10W700LRP | 6.1-9.0W | |
| | Maximum power | 10.8W | |
| Dimming | Dimming control | NA | |
| | Dimming technique | NA | |
| | PWM frequency | NA | |
| | Dimming range | NA | |
| | Lowest dimming current | NA | |
| | Galvanic isolation | NA | |
| | Ambient temperature range t_a | -20°C - +60°C | |
| | Maximum case temperature t_c | | |
| | G6R10W200/250/350LRP | 80°C | |
| | G6R10W500/600/700LRP | 85°C | |
| | Max. case temp. in fault condition | 110°C | When operating under fault conditions, the temperature of the enclosure at any location should not exceed 110 °C |
| Environment | Storage temperature range | -40°C - +85°C | |
| | Relative humidity | 10% - 95% | |
| | Surge transient protection | 1 kV | L/N |
| | Environmental rating | Indoor | |
| | IP rating | IP20 | |
| | Mains switching cycles | > 100,000 | |
| | Expected lifetime | | |
| | G6R10W200/250/350LRP | Full Load > 50,000 h,tc 80°C@ta 60°C | 0.2 % / 1,000 h failure rate |
| | G6R10W500/600/700LRP | Full Load > 50,000 h,tc 85°C@ta 60°C | 0.2 % / 1,000 h failure rate |

| | | |
|----------------|------------------|------------------------|
| Packing | Gross weight/box | 10.3 kg |
| | Net weight/box | 9.4 kg |
| | Pcs/box | 180 PCS |
| | Dimension/box | 385(L)*310(W)*260(H)mm |

Protections

| | |
|---------------------------|---------------|
| Short- circuit protection | Auto recovery |
| Open- circuit protection | Auto recovery |
| Overload protection | Auto recovery |

Conformity & Standards

| | |
|------------------|--|
| Safety standard: | EN 61347-1, EN 61347-2-13, EN 62493 |
| Performance: | EN 62384 |
| EMC standard: | EN 55015, EN 61000-3-2, EN 61000-3-3, EN 61547 |

Cable information

| | | |
|-----------------------|-------|-------|
| PRI Connection | L | N |
| Color | Brown | Blue |
| Wire type | 7022 | 7022 |
| Wire diameter | AWG20 | AWG20 |
| Wire length | 140mm | 142mm |
| Stripping | 6mm | 6mm |
| Tolerance | ±5mm | ±5mm |

| | | |
|-----------------------|-------|-------|
| SEC Connection | + | - |
| Color | Red | Black |
| Wire type | 1332 | 1332 |
| Wire diameter | AWG22 | AWG22 |
| Wire length | 142mm | 142mm |
| Stripping | 6mm | 6mm |
| Tolerance | ±5mm | ±5mm |

Subject to change without notice, HEP guarantees all products perform functionally well

* If not mentioned, all the test conditions are based on full load at 230VAC input (for 220-240 VAC input).

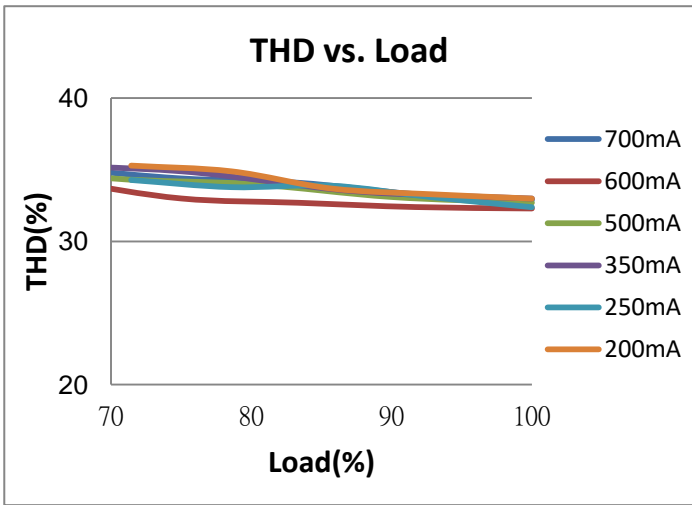
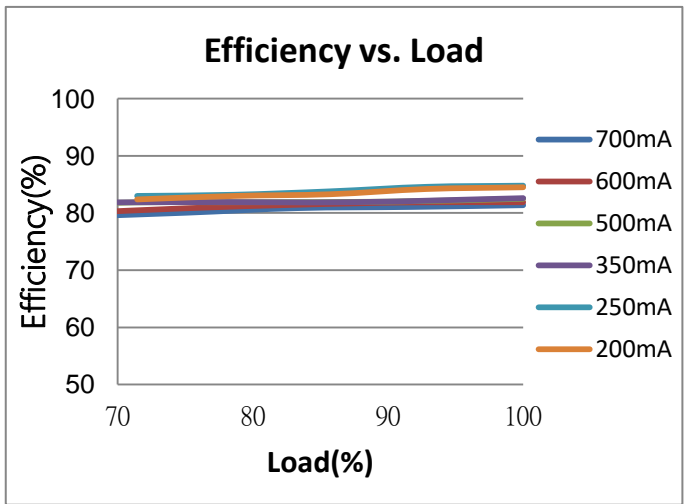
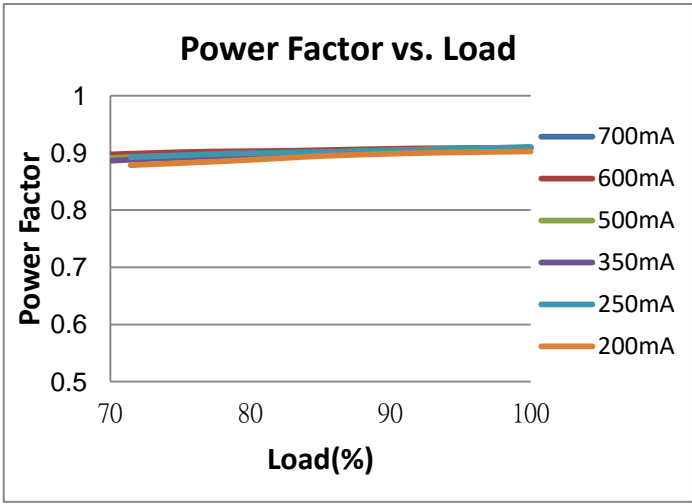

**Physical
Parameter**

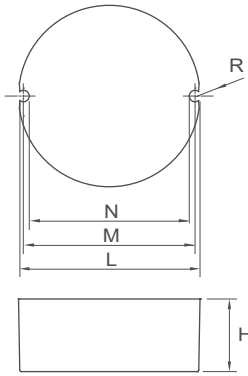

L : 48 mm M : 46.7 mm N : 43.5 mm
 H : 22 mm R : 1.6 mm

Tolerance : +/-1 mm , R : +/-0.5 mm

Housing Material : Polycarbonate / Potting
 Soldering : Lead-Free, Comply With RoHS
 Label : Surface Print

Wiring Diagram

