



### Approval Marks



Item	Value	Remark
Nominal voltage	220–240V	
Nominal frequency	0 / 50–60Hz	
AC voltage range	198–264V	
DC voltage range (start)	NA	
DC voltage range (operation)	NA	
Maximum voltage	280Vac	2 h maximum. unit might not operate in this abnormal condition
Nominal current	85mA	
Total Harmonic Distortion (THD)	NA	Full load @230VAC
Power factor	0.5C	Full load @230VAC
Displacement factor	0.5C	Full load @230VAC
Efficiency		
G5S7W150/350/500LR-Z	80%	Full load @230VAC
G5S7W700LR-Z	78%	Full load @230VAC
No-load power	NA	
Stand-by power	NA	
Protection class	II	Suitable for class II luminaires
Inrush current	40 A / 55 $\mu$ s	
Max.units per circuit breaker	Type B , 10A MCB	40
	Type B , 16A MCB	64
	Type C , 10A MCB	59
	Type C , 16A MCB	94
Earth leakage current	NA	
Nominal voltage range		
G5S7W150LR-Z	32-42 Vdc	
G5S7W350LR-Z	13-22 Vdc	
G5S7W500LR-Z	6-13 Vdc	
G5S7W700LR-Z	5.5-9 Vdc	
Maximum voltage		
G5S7W150LR-Z	55Vdc	
G5S7W350LR-Z	35Vdc	
G5S7W500LR-Z	25Vdc	
G5S7W700LR-Z	25Vdc	

	Item	Value	Remark
Output	Nominal current range		
	G5S7W150LR-Z	150mA	
	G5S7W350LR-Z	350mA	
	G5S7W500LR-Z	500mA	
	G5S7W700LR-Z	700mA	
	Current accuracy	± 5%	Full load @230VAC
	Typical output LF current ripple	± 5%	Low Frequency< 120Hz Full load @230VAC
	Starting time	< 0.5S	Full load @230VAC
	Nominal power range		
	G5S7W150LR-Z	4.8-6.3W	
G5S7W350LR-Z	4.55-7.7W		
G5S7W500LR-Z	3-6.5W		
G5S7W700LR-Z	3.85-6.3W		
Maximum power	7.7W		
Dimming	Dimming control	NA	
	Dimming technique	NA	
	PWM frequency	NA	
	Dimming range	NA	
	Lowest dimming current	NA	
	Galvanic isolation	NA	
Environment	Ambient temperature range t <sub>a</sub>	-20°C - +50°C	
	Maximum case temperature t <sub>c</sub>	85°C	
	Max. case temp. in fault condition	110°C	When operating under fault conditions, the temperature of the enclosure at any location should not exceed 110 °C
	Storage temperature range	-25°C - +85°C	
	Relative humidity	10% - 95%	
	Surge transient protection	1kV	L/N
	Environmental rating	Indoor	
	IP rating	IP20	
	Mains switching cycles	< 100,000	
	Expected lifetime	> 50,000 h, tc 85 °C @ ta 50 °C	0.1 % / 1,000 h failure rate
Packing	Gross weight/box	6.8 kg	
	Net weight/box	5.7 kg	
	Pcs/box	168 PCS	
	Dimension/box	385(L)*310(W)*260(H)mm	
<b>Protections</b>			
Short- circuit protection		Auto recovery	
Open- circuit protection		Auto recovery	
Overload protection		Auto recovery	
<b>Conformity &amp; Standards</b>			
Safety standard:		EN 61347-1, EN 61347-2-13, EN 62493	
Performance:		EN 62384	
CCC standard:		GB17625.1,GB/T17743,GB19510.1,GB19510.14	
EMC standard:		EN 55015, EN 61000-3-2, EN 61000-3-3, EN 61547	

## Cable information

### PRI

Cable cross-section	0.5-1.5□/AWG 20-16
Stripping	6mm
Pull test cable type	H03VV(H2)-F 2x0,75-1,5 mm <sup>2</sup> ,H05VV(H2)-F 2x0,75-1,5 mm <sup>2</sup>

### SEC

Cable cross-section	0.5-1.5□/AWG 20-16
Stripping	6mm

### Terminal information

PRI-Screw type

SEC-Screw type

\* If not mentioned, all the test conditions are based on full load at 230VAC input (for 220-240 VAC input).

\*Subject to change without notice, HEP guarantees all products perform functionally well\*

## Electrical Values

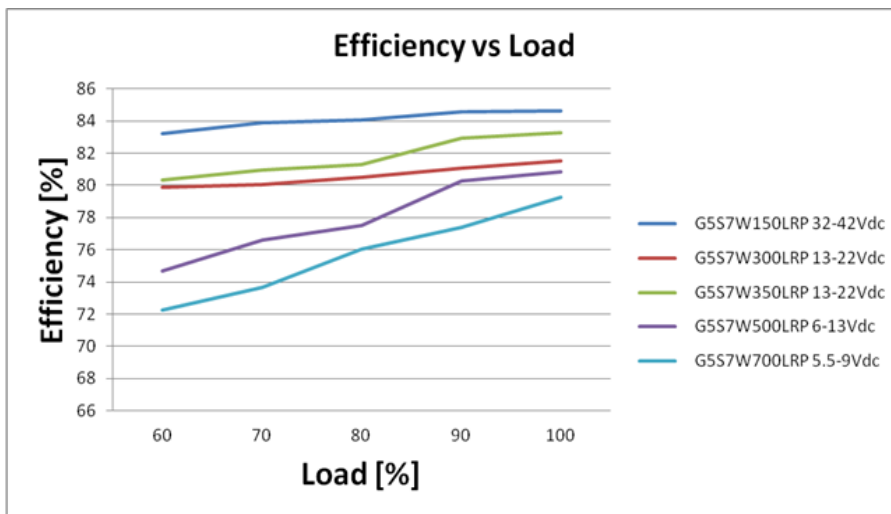

## Physical

### Parameter

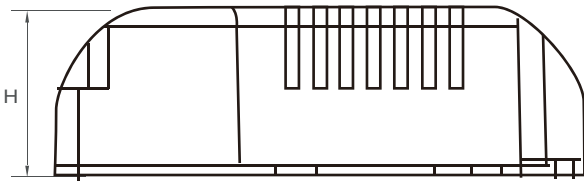
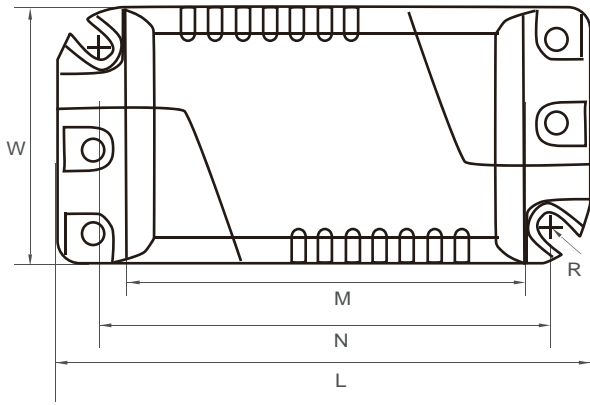

L : 68.4 mm    H : 21.8 mm  
M : 57.6 mm    R : 3.2 mm  
N : 46.2 mm  
W : 33.2 mm

Tolerance :  $\geq 0 \sim 100 \geq \pm 0.5 \text{ mm}$   
 $100 \geq \pm 1 \text{ mm}$

Housing Material : Polycarbonate

Soldering                    Lead-Free, Comply With RoHS

Label                         Surface Print

## Wiring Diagram

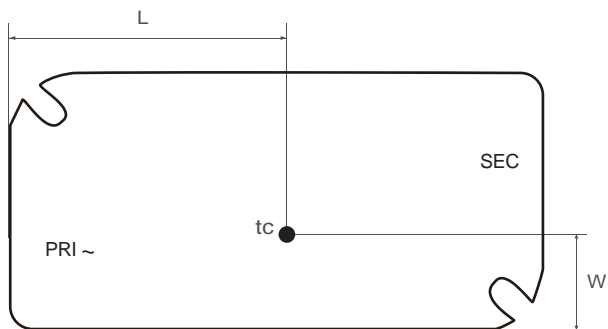
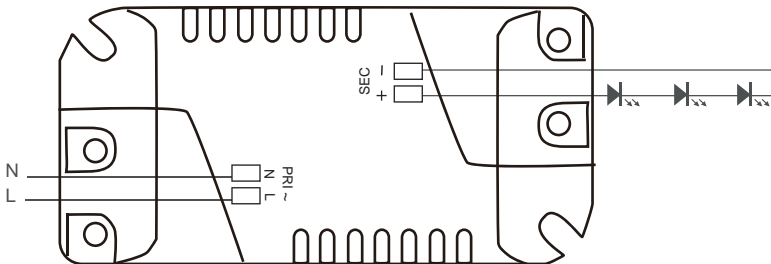

L : 37.5mm    W : 10.5mm