



### Approval Marks



Item	Value	Remark		
Nominal voltage	220–240V			
Nominal frequency	0 / 50–60Hz			
AC voltage range	198–264V			
DC voltage range (start)	NA			
DC voltage range (operation)	NA			
Nominal current	120mA			
Total Harmonic Distortion (THD)	< 20%	Full load @230VAC		
Power factor	0.91C-0.97	Full load @230VAC		
Input	Displacement factor	0.91C-0.97	Full load @230VAC	
	Efficiency	86% (Typ.)	Full load @230VAC	
	No-load power	NA		
	Stand-by power	NA		
	Protection class	NA		
	Inrush current	12A / 26us		
	Max.units per circuit breaker	Type B , 10A MCB	33	
		Type B , 16A MCB	53	
		Type C , 10A MCB	42	
		Type C , 16A MCB	67	
Earth leakage current	NA			
Output	Nominal voltage range	25-42Vdc		
	Maximum voltage	55Vdc		
	Nominal current range	500mA		
	Current accuracy	± 5%		
	Typical output LF current ripple	± 5%	Low Frequency< 120Hz Full load @230VAC	
	SVM	≤ 0.4	Full load @230VAC	
	PstLM	≤ 1	Full load @230VAC	
	Starting time	< 0.5 S	Full load @230VAC	
	Nominal power range	12.5-21W		
	Maximum power	21W		

	Item	Value	Remark
Dimming	Dimming control	Trailing Edge	
	Dimming technique	Amplitude	
	PWM frequency	NA	
	Dimming range	10-100%	
	Lowest dimming current	2-6%	
	Galvanic isolation	NA	
Environment	Ambient temperature range $t_a$	-20°C - +50°C	
	Maximum case temperature $t_c$	75°C	
	Max. case temp. in fault condition	110°C	When operating under fault conditions, the temperature of the enclosure at any location should not exceed 110 °C
	Storage temperature range	-40°C - +85°C	
	Relative humidity	10% - 95%	
	Surge transient protection	1 kV	L/N
	Environmental rating	Indoor	
	IP rating	IP20	
	Mains switching cycles	> 100,000	
	Expected lifetime	> 50,000 h, $t_c$ 75 °C @ $t_a$ 50 °C > 100000 h, $t_c$ 65 °C @ $t_a$ 40 °C	0.2 % / 1,000 h failure rate 0.1 % / 1,000 h failure rate
Packing	Gross weight/box	9.4 kg	
	Net weight/box	8.4 kg	
	Pcs/box	56 PCS	
	Dimension/box	490(L)*270(W)*225(H)mm	
<b>Protections</b>			
Safety standard:	EN 61347-1, EN 61347-2-13, EN 62493		
Performance:	EN 62384		
EMC standard:	EN 55015, EN 61000-3-2, EN 61000-3-3, EN 61547		
<b>Conformity &amp; Standards</b>			
Safety standard:	EN 61347-1, EN 61347-2-13, EN 62493		
Performance:	EN 62384		
EMC standard:	EN 55015, EN 61000-3-2, EN 61000-3-3, EN 61547		
SAA standard:	AS/NZS 61347.1, AS/NZS IEC 61347.2.13		
<b>Cable information</b>			
<b>PRI</b> Connection	L	N	
Color	Brown	Blue	
Wire type	7022	7022	
Wire diameter	AWG20	AWG20	
Wire length	143mm	143mm	
Stripping	6mm	6mm	
tolerance	±5mm	±5mm	
<b>SEC</b> Connection	+	-	
Color	Red	Black	
Wire type	1332	1332	
Wire diameter	AWG22	AWG22	
Wire length	142mm	142mm	
Stripping	6mm	6mm	
tolerance	±5mm	±5mm	

\*Subject to change without notice, HEP guarantees all products perform functionally well\*

\* If not mentioned, all the test conditions are based on full load at 230VAC input (for 220-240 VAC input).

Trailing Edge Dimmer list approved by HEP

Manufacturer	Model	Q'ty of parallelconnection
Philips	SED-200A	8
Merten/Schneider	SBD315RC	12
Etman	ETM327	12
Etman	ETM329	12
CASAMBI	CBU-TED	4

Electrical Values

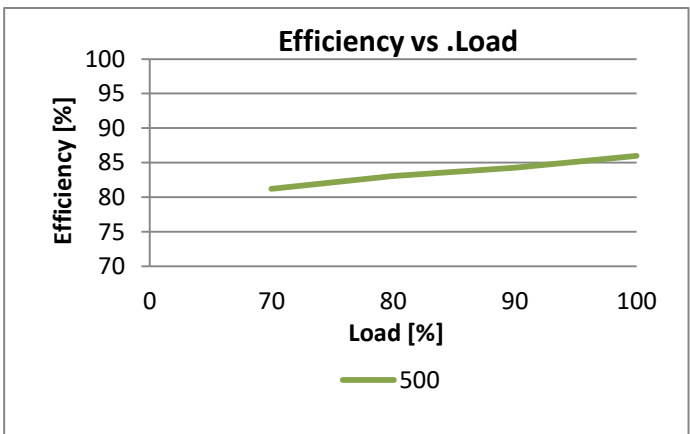
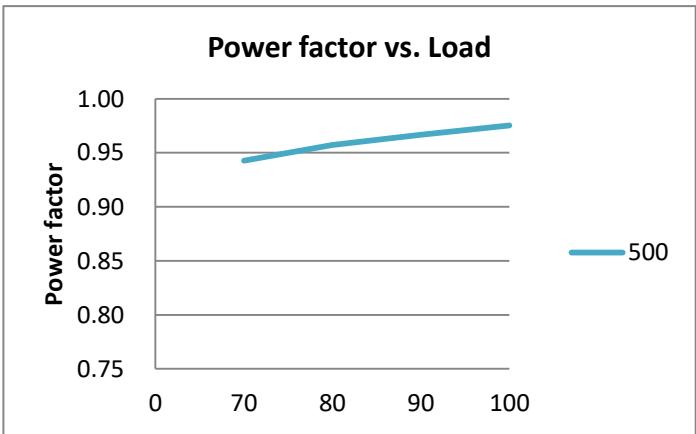
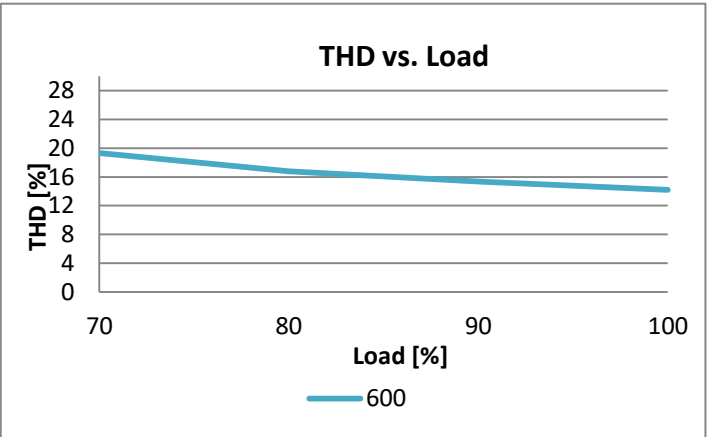
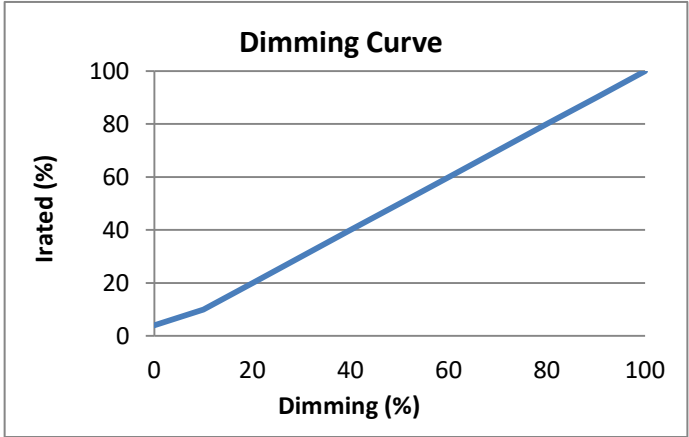

**Physical Parameter**

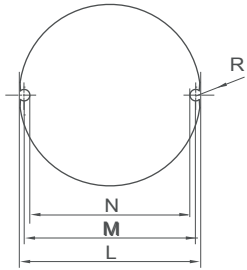

L : 55 mm    M : 52 mm    H : 22 mm  
 R : 1.7 mm    N : 48.5 mm

Tolerance : +/-1 mm , R : +/-0.5 mm

Housing Material : Polycarbonate / Potting  
 Soldering : Lead-Free, Comply With RoHS  
 Label : Surface Print

**Wiring Diagram**

