



	Item	Value	Remark
Input	Nominal voltage	220–240V	
	Nominal frequency	50–60Hz	
	AC voltage range		
	G5R7W350/500LRP	198–264V	
	DC voltage range (start)	NA	
	DC voltage range (operation)	NA	
	Nominal current	85mA	
	Total Harmonic Distortion (THD)	NA	Full load @230VAC
	Power factor	0.5C	Full load @230VAC
	Displacement factor	0.5C	Full load @230VAC
	Efficiency		Full load @230VAC
	G5R7W350/500LRP	80% (Typ.)	Full load @230VAC
	No-load power	NA	
	Stand-by power	NA	
	Protection class	NA	
Inrush current	30A / 70us		
Max.units per circuit breaker	Type B , 10A MCB	40	
	Type B , 16A MCB	64	
	Type C , 10A MCB	59	
	Type C , 16A MCB	94	
Earth leakage current	NA		
Output	Nominal voltage range		
	G5R7W350LRP	13-22Vdc	
	G5R7W500LRP	6-13Vdc	
	Maximum voltage		
	G5R7W350LRP	35Vdc	
	G5R7W500LRP	18Vdc	
	Nominal current range		
	G5R7W350LRP	350mA	
	G5R7W500LRP	500mA	
	Current accuracy	± 5%	Full load @230VAC
Typical output LF current ripple	± 5%	Low Frequency < 120Hz Full load @230VAC	

	Item	Value	Remark
Output	Starting time	< 0.5 S	Full load @230VAC
	Nominal power range		
	G5R7W350LRP	4.6-7.7W	
	G5R7W500LRP	3-6.5W	
	Maximum power	7.7W	
Dimming	Dimming control	NA	
	Dimming technique	NA	
	PWM frequency	NA	
	Dimming range	NA	
	Lowest dimming current	NA	
	Galvanic isolation	NA	
Environment	Ambient temperature range t_a	-20°C - +50°C	
	Maximum case temperature t_c	75°C	
	Max. case temp. in fault condition	110°C	When operating under fault conditions, the temperature of the enclosure at any location should not exceed 110 °C
	Storage temperature range	-25°C - +85°C	
	Relative humidity	10% - 95%	
	Surge transient protection	1 kV	L/N
	Environmental rating	Indoor	
	IP rating	IP20	
	Mains switching cycles	> 100,000	
	Expected lifetime		
		Output load 3~7.7W	> 80,000 h, t_c 65 °C @ t_a 40 °C > 50,000 h, t_c 75 °C @ t_a 50 °C
	Output load 3~5.2W	> 50,000 h, t_c 75 °C @ t_a 60 °C	0.2 % / 1,000 h failure rate
Packing	Gross weight/box	11.4 kg	
	Net weight/box	10.4 kg	
	Pcs/box	90 PCS	
	Dimension/box	240(L)*190(W)*185(H)mm	
Protections			
	Short-circuit Protection	Auto recovery	
	Open-circuit Protection	Auto recovery	
	Overload Protection	Auto recovery	
Conformity & Standards			
	Safety standard:	EN 61347-1, EN 61347-2-13, EN 62493	
	Performance:	EN 62384	
	EMC standard:	EN 55015, EN 61000-3-2, EN 61000-3-3, EN 61547	
	SAA standard:	AS/NZS 61347.1, AS/NZS IEC 61347.2.13	

Cable information

PRI Connection	L	N
Color	Blue	Brown
Wire type	7022	7022
Wire diameter	AWG20	AWG20
Wire length	141mm	140mm
Stripping	6mm	6mm
Tolerance	±5mm	±5mm
SEC Connection	+	-
Color	Red	Black
Wire type	1332	1332
Wire diameter	AWG22	AWG22
Wire length	142mm	143mm
Stripping	6mm	6mm
Tolerance	±5mm	±5mm

Subject to change without notice, HEP guarantees all products perform functionally well

* If not mentioned, all the test conditions are based on full load at 230VAC input (for 220-240 VAC input).

Electrical Values

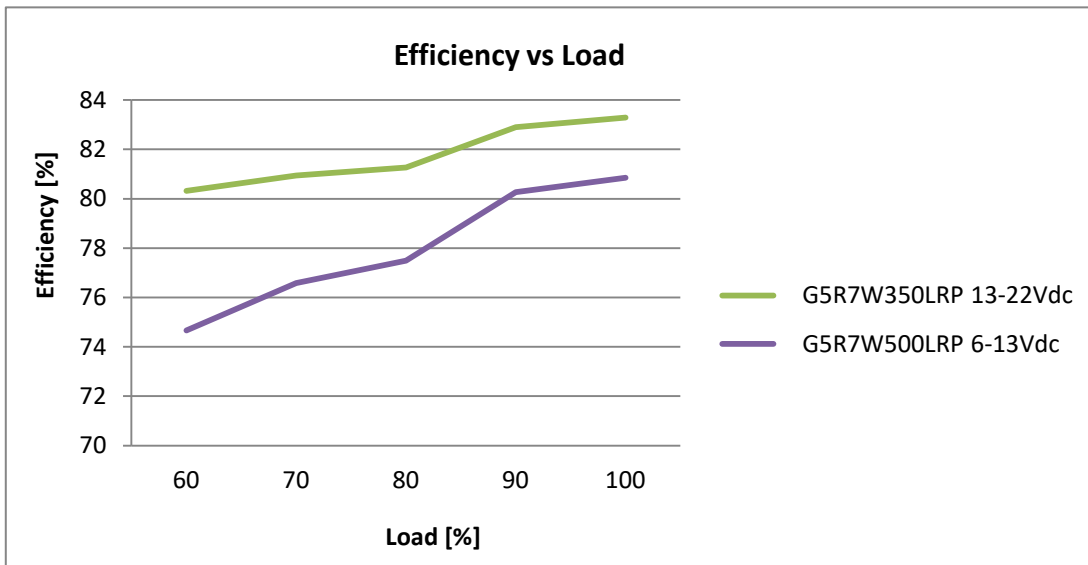

Physical Parameter

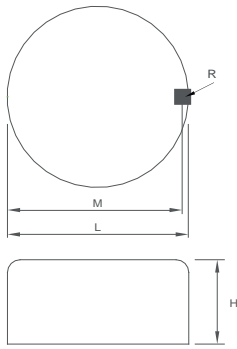

L : 43 mm H : 20 mm
M : 41.5 mm R : 1.6 mm
Tolerance : +/-1 mm , R : +/-0.5 mm

Housing Material : Polycarbonate / Potting
Soldering : Lead-Free, Comply With RoHS
Label : Surface Print

Wiring Diagram

