

Approval Marks



	Item	Value	Remark
Input	Nominal voltage	220–240V	
	Nominal frequency	50–60Hz	
	AC voltage range	198–264V	
	DC voltage range (start)	NA	
	DC voltage range (operation)	NA	
	Nominal current		
	G5R15W300LRP	75mA	
	G5R15W350LRP	85mA	
	Total Harmonic Distortion (THD)	< 15%	Full load @230VAC
	Power factor(Displacement factor)	0.85C-0.9C	Full load @230VAC
	Displacement factor	0.85C-0.9C	Full load @230VAC
	Efficiency	85%(Typ.)	Full load @230VAC
	No-load power	NA	
	Stand-by power	NA	
Protection class	NA		
Inrush current	9A / 140us		
Max.units per circuit breaker	Type B , 10A MCB	47	
	Type B , 16A MCB	75	
	Type C , 10A MCB	59	
	Type C , 16A MCB	94	
Earth leakage current	NA		
Output	Nominal voltage range		
	G5R15W300LRP	26-43Vdc	
	G5R15W350LRP	26-43Vdc	
	Maximum voltage		
	G5R15W300LRP	50Vdc	
	G5R15W350LRP	50Vdc	
	Nominal current range		Full load @230VAC
	G5R15W300LRP	300mA	
G5R15W350LRP	350mA		

	Item	Value	Remark
Output	Current accuracy	± 5%	Full load @230VAC
	Typical output LF current ripple	± 5%	Low Frequency< 120Hz Full load @230VAC
	Starting time	< 0.5S	Full load @230VAC
	SVM	≤ 0.4	Full load @230VAC
	P _{stLM}	≤ 1	Full load @230VAC
	Nominal power range		
	G5R15W300LRP	7.5-13W	
G5R15W350LRP	9-15W		
Maximum power	15W		
Dimming	Dimming control	NA	
	Dimming technique	NA	
	PWM frequency	NA	
	Dimming range	NA	
	Lowest dimming current	NA	
	Galvanic isolation	NA	
Environment	Ambient temperature range t _a	-20°C - +50°C	
	Maximum case temperature t _c	90°C	
	Max. case temp. in fault condition	110°C	
	Storage temperature range	-40°C - +85°C	
	Relative humidity	10% - 95%	
	Surge transient protection	1 kV,2kV	L/N,L-PE/N-PE
	Environmental rating	Indoor	
	IP rating	IP20	
	Mains switching cycles	> 100,000	
	Expected lifetime		
Output load 7.5-15W	> 50,000 h, t _c 90 °C @ t _a 50 °C	0.2 % / 1,000 h failure rate	
Output load 7.5-15W	> 41,000 h, t _c 90 °C @ t _a 60 °C	0.24 % / 1,000 h failure rate	
Packing	Gross weight/box	12.2 kg	
	Net weight/box	11 kg	
	Pcs/box	180 PCS	
	Dimension/box	385(L)*310(W)*260(H)mm	
Protections			
Short-circuit Protection		Auto recovery	
Open-circuit Protection		Auto recovery	
Overload Protection		Auto recovery	
Conformity & Standards			
Safety standard:	EN 61347-1, EN 61347-2-13, EN 62493		
Performance:	EN 62384		
CCC standard:	GB17625.1,GB/T17743,GB19510.1,GB19510.14		
EMC standard:	EN 55015, EN 61000-3-2, EN 61000-3-3, EN 61547		

Cable information

PRI Connection	L	N
Color	Brown	Blue
Wire type	7022	7022
Wire diameter	AWG20	AWG20
Wire length	143mm	143mm
Stripping	6mm	6mm
tolerance	±5mm	±5mm

Sec Connection	+	-
Color	Red	Black
Wire type	1332	1332
Wire diameter	AWG22	AWG22
Wire length	142mm	142mm
Stripping	6mm	6mm
tolerance	±5mm	±5mm

* If not mentioned, all the test conditions are based on full load at 230VAC input (for 220-240 VAC input).

Subject to change without notice, HEP guarantees all products perform functionally well

Electrical Values

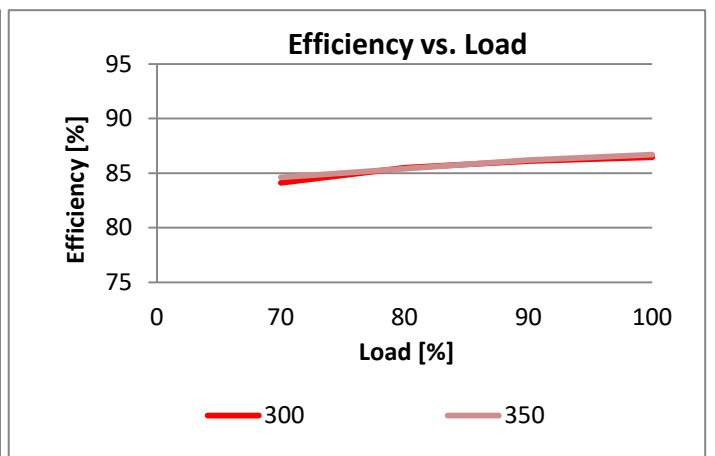
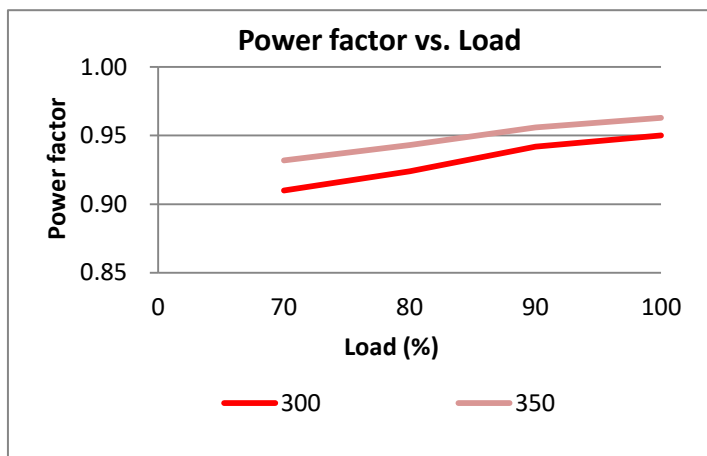
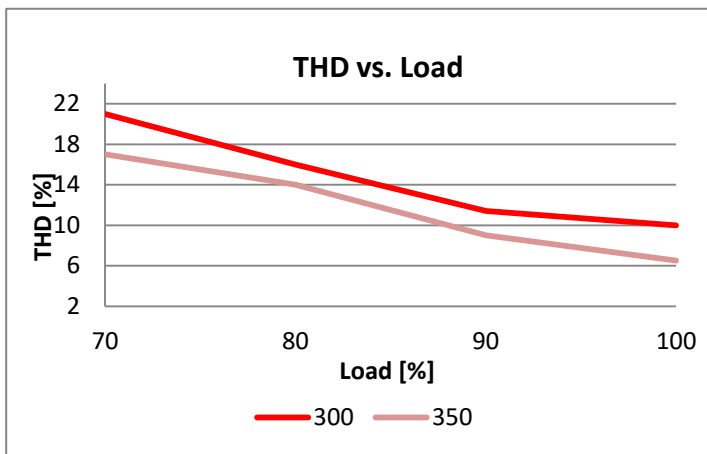

**Physical
Parameter**

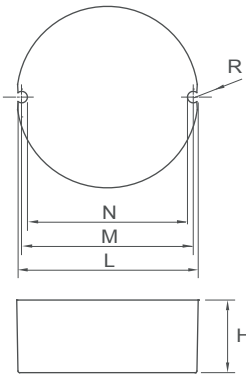

L : 48 mm M : 46.7 mm N : 43.5 mm

H : 22 mm R : 1.6 mm

Tolerance : +/-1 mm , R : +/-0.5 mm

Housing Material : Polycarbonate / Potting

Soldering : Lead-Free, Comply With RoHS

Label : Surface Print

TC point at bottom side of the case

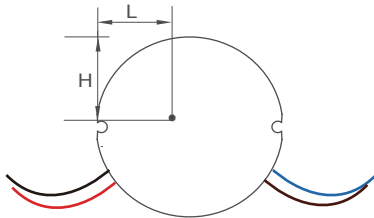

L : 17.5 mm H : 19.5 mm

Wiring Diagram

