

### Approval Marks



Item	Value	Remark
Nominal voltage	220-240V	
Nominal frequency	50-60Hz	
AC voltage range	198-264V	
DC voltage range (start)	NA	
DC voltage range (operation)	NA	
Nominal current		
G5R10W200LRP	60mA	
G5R10W250/350/700LRP	65mA	
Total Harmonic Distortion (THD)	< 15%	Full load @ 230VAC
Power factor(Displacement factor)	0.8C-0.9C	Full load @ 230VAC
Displacement factor	0.8C-0.9C	Full load @ 230VAC
Efficiency	83%(Typ.)	Full load @ 230VAC
No-load power	NA	
Stand-by power	NA	
Protection class	NA	
Inrush current	8.5A / 140uS	
Max.units per circuit breaker	Type B , 10A MCB	62
	Type B , 16A MCB	98
	Type C , 10A MCB	77
	Type C , 16A MCB	123
Earth leakage current	NA	
Nominal voltage range		
G5R10W200/250LRP	30-42Vdc	
G5R10W350LRP	13-26Vdc	
G5R10W700LRP	8.6-12.9Vdc	
Maximum voltage		
G5R10W200/250LRP	50Vdc	
G5R10W350LRP	35Vdc	
G5R10W700LRP	20Vdc	
Nominal current range		Full load @ 230VAC

	Item	Value	Remark
	G5R10W200LRP	200mA	
	G5R10W250LRP	250mA	
	G5R10W350LRP	350mA	
	G5R10W700LRP	700mA	
	Current accuracy	± 5%	Full load @ 230VAC
Output	Typical output LF current ripple	± 4%	Low Frequency < 120Hz Full load @ 230VAC
	Starting time	< 0.5S	Full load @ 230VAC
	SVM	≤ 0.4	Full load @ 230VAC
	P <sub>stLM</sub>	≤ 1	Full load @ 230VAC
	Nominal power range		
	G5R10W200LRP	6-9W	
	G5R10W250LRP	7.5-10W	
	G5R10W350LRP	4.5-10W	
	G5R10W700LRP	6-10W	
	Maximum power	10W	
Dimming	Dimming control	NA	
	Dimming technique	NA	
	PWM frequency	NA	
	Dimming range	NA	
	Lowest dimming current	NA	
	Galvanic isolation	NA	
	Ambient temperature range t <sub>a</sub>	-20°C - +50°C	
	Maximum case temperature t <sub>c</sub>	90°C	
	Max. case temp. in fault condition	110°C	When operating under fault conditions, the temperature of the enclosure at any location should not exceed 110 °C
Environment	Storage temperature range	-40°C - +85°C	
	Relative humidity	10% - 95%	
	Surge transient protection	1 kV,2kV	L/N,L-PE/N-PE
	Environmental rating	Indoor	
	IP rating	IP20	
	Mains switching cycles	> 100,000	
	Expected lifetime		
	Full load	> 50,000 h, t <sub>c</sub> 90 °C @ t <sub>a</sub> 50 °C	0.2 % / 1,000 h failure rate
Packing	Gross weight/box	10.3 kg	
	Net weight/box	9.4 kg	
	Pcs/box	180 PCS	
	Dimension/box	385(L)*310(W)*260(H)mm	
<b>Protections</b>			
	Short-circuit Protection	Auto recovery	
	Open-circuit Protection	Auto recovery	
	Overload Protection	Auto recovery	
<b>Conformity &amp; Standards</b>			
	Safety standard:	EN 61347-1, EN 61347-2-13, EN 62493	
	Performance:	EN 62384	
	CCC standard:	GB17625.1,GB/T17743,GB19510.1,GB19510.14	
	EMC standard:	EN 55015, EN 61000-3-2, EN 61000-3-3, EN 61547	

## Cable information

<b>PRI</b> Connection	L	N
Color	Brown	Blue
Wire type	7022	7022
Wire diameter	AWG20	AWG20
Wire length	143mm	143mm
Stripping	6mm	6mm
tolerance	±5mm	±5mm

<b>SEC</b> Connection	+	-
Color	Red	Black
Wire type	1332	1332
Wire diameter	AWG22	AWG22
Wire length	142mm	142mm
Stripping	6mm	6mm
tolerance	±5mm	±5mm

\*Subject to change without notice, HEP guarantees all products perform functionally well\*

\* If not mentioned, all the test conditions are based on full load at 230VAC input (for 220-240 VAC input).

## Electrical Values

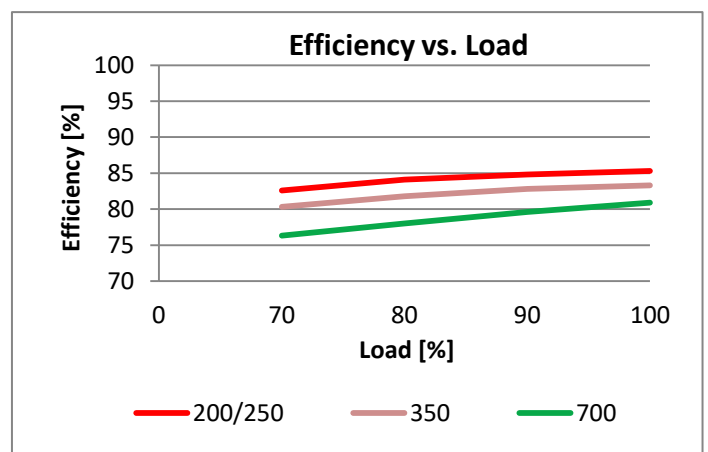
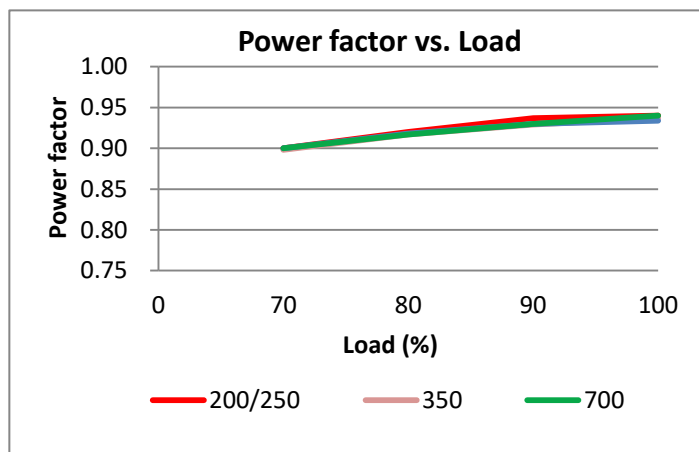
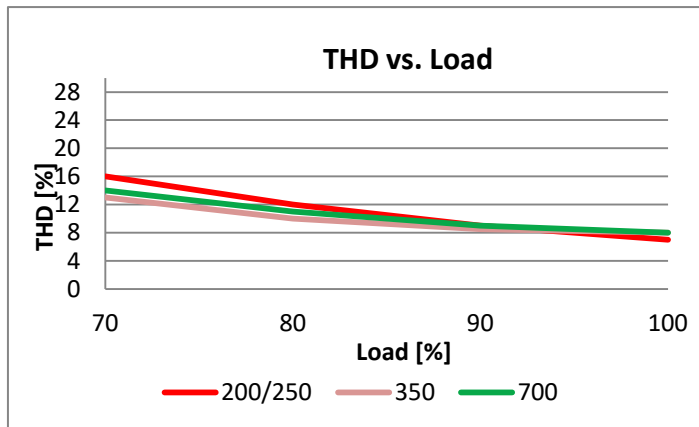

**Physical  
Parameter**

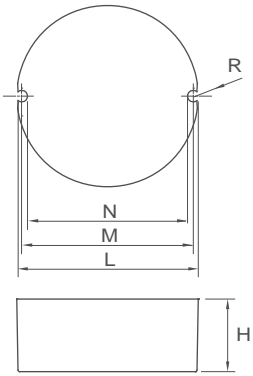

L : 48 mm    M : 46.7 mm    N : 43.5 mm

H : 22 mm    R : 1.6 mm

Tolerance : +/-1 mm , R : +/-0.5 mm

Housing Material : Polycarbonate / Potting

Soldering : Lead-Free, Comply With RoHS

Label : Surface Print

**Wiring Diagram**

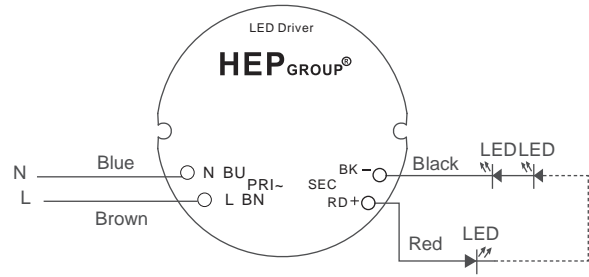

**TC point at bottom side of the case**

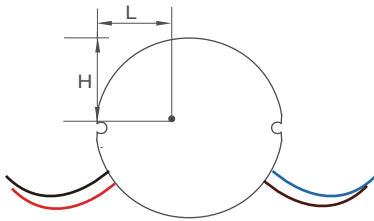

L : 17.5 mm    H : 19.5 mm